



See More Online

KFB: Key Facts For Buyers

A Guide to This Property & the Local Area

Wednesday 18th December 2024



PRESTON ROAD, RIBCHESTER, PRESTON, PR3

Pendle Hill Properties

154 Whalley Road Read BB12 7PN

01282 772048

andrew@pendlehillproperties.co.uk

www.pendlehillproperties.co.uk





Property

Type:	Terraced	Tenure:	Freehold
Bedrooms:	4		
Floor Area:	1,223 ft ² / 113 m ²		
Plot Area:	0.06 acres		
Year Built :	1930-1949		
Council Tax :	Band B		
Annual Estimate:	£1,709		
Title Number:	LA886437		

Local Area

Local Authority:	Lancashire	Estimated Broadband Speeds (Standard - Superfast - Ultrafast)	
Conservation Area:	No		
Flood Risk:			
• Rivers & Seas	No Risk	19 mb/s	- mb/s
• Surface Water	High		

Mobile Coverage: (based on calls indoors)				Satellite/Fibre TV Availability:		
O ₂	EE	3	O2	BT	sky	Virgin media



PRESTON ROAD, RIBCHESTER, PRESTON, PR3

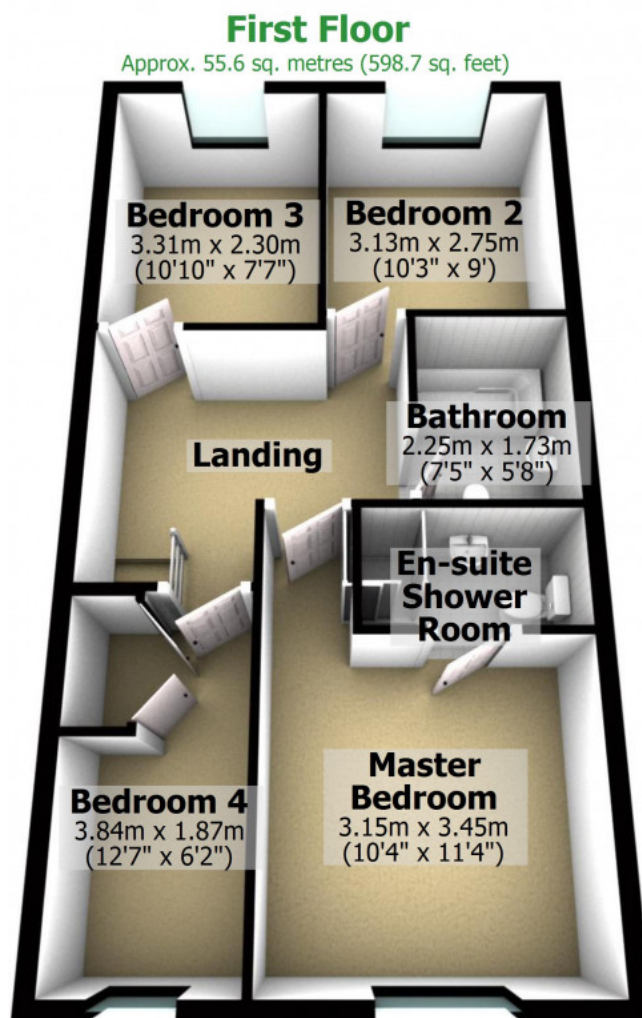

PRESTON ROAD, RIBCHESTER, PRESTON, PR3

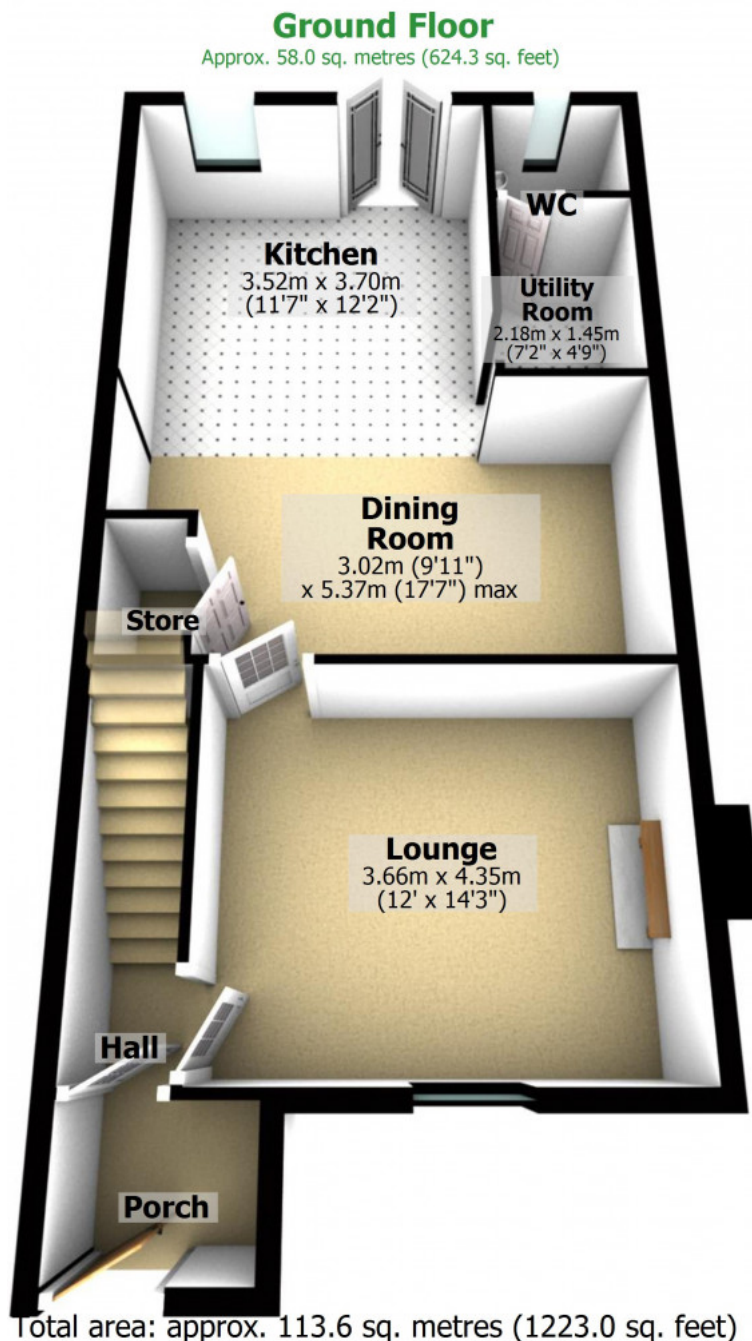

For illustrative purposes only. Not to scale. All sizes are approximate.
Plan produced using PlanUp.

Property
EPC - Certificate

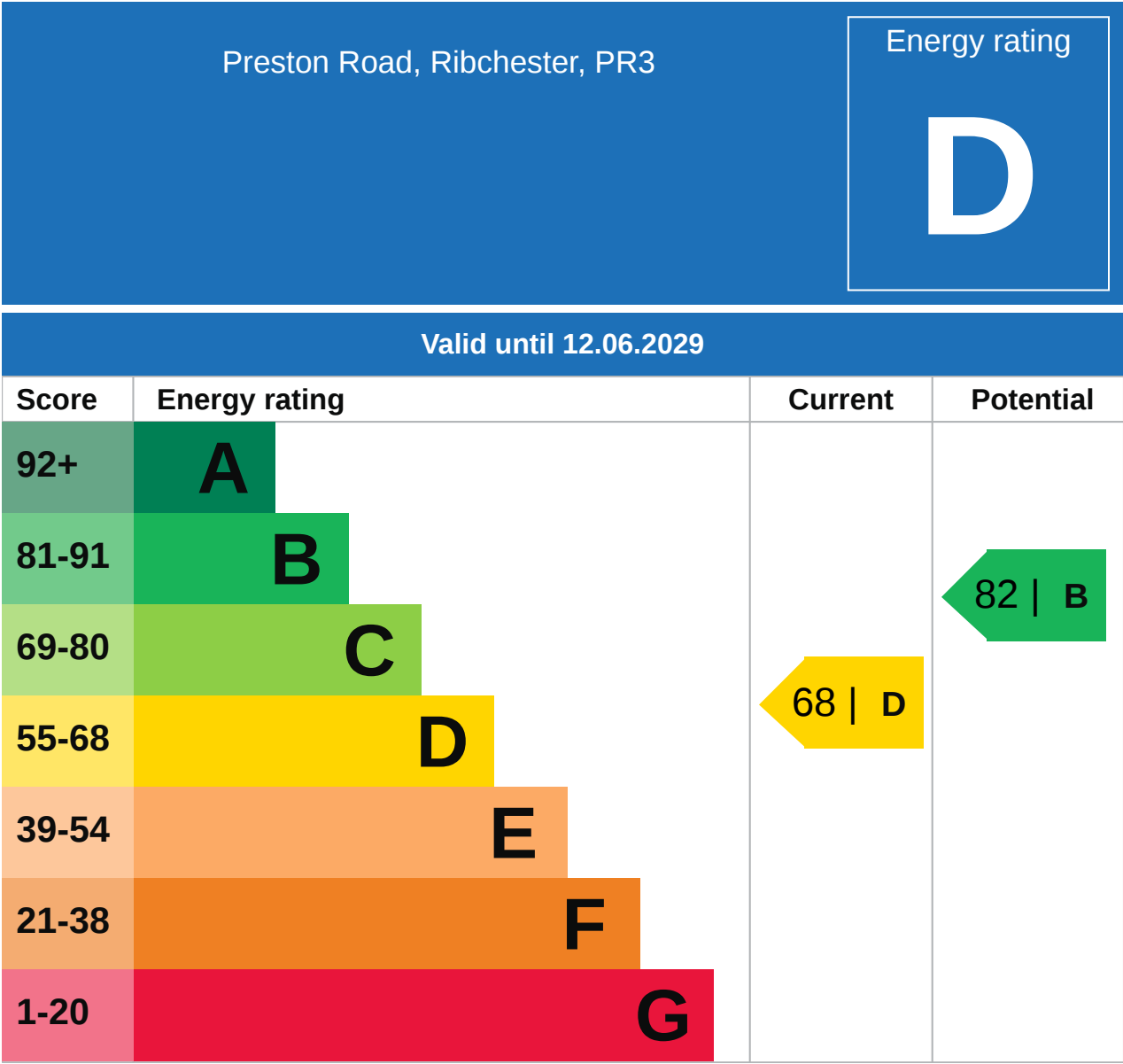





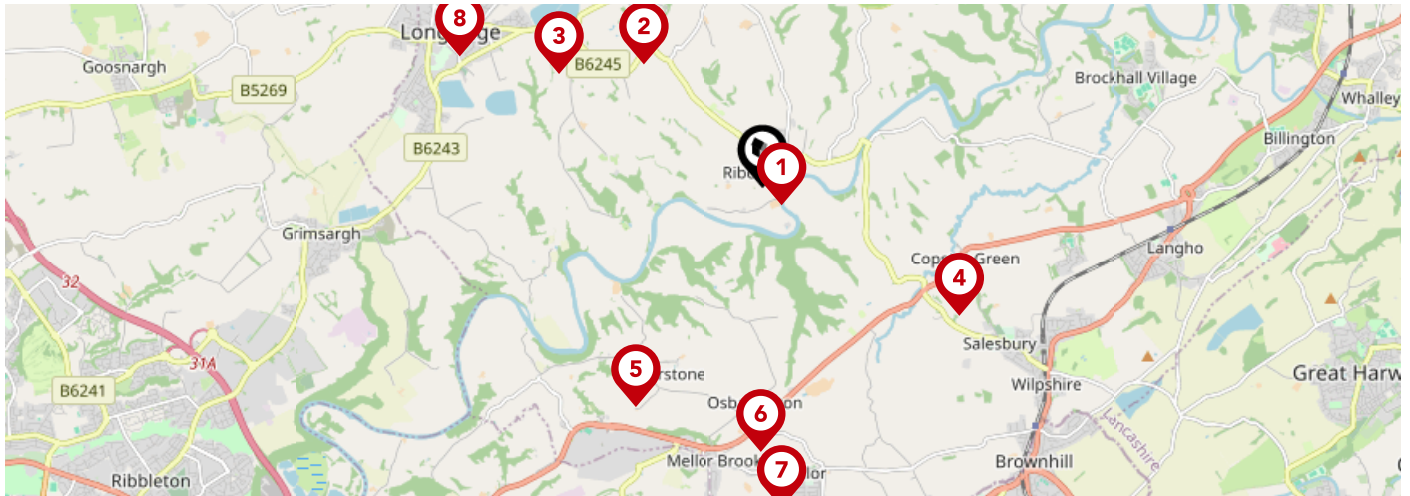

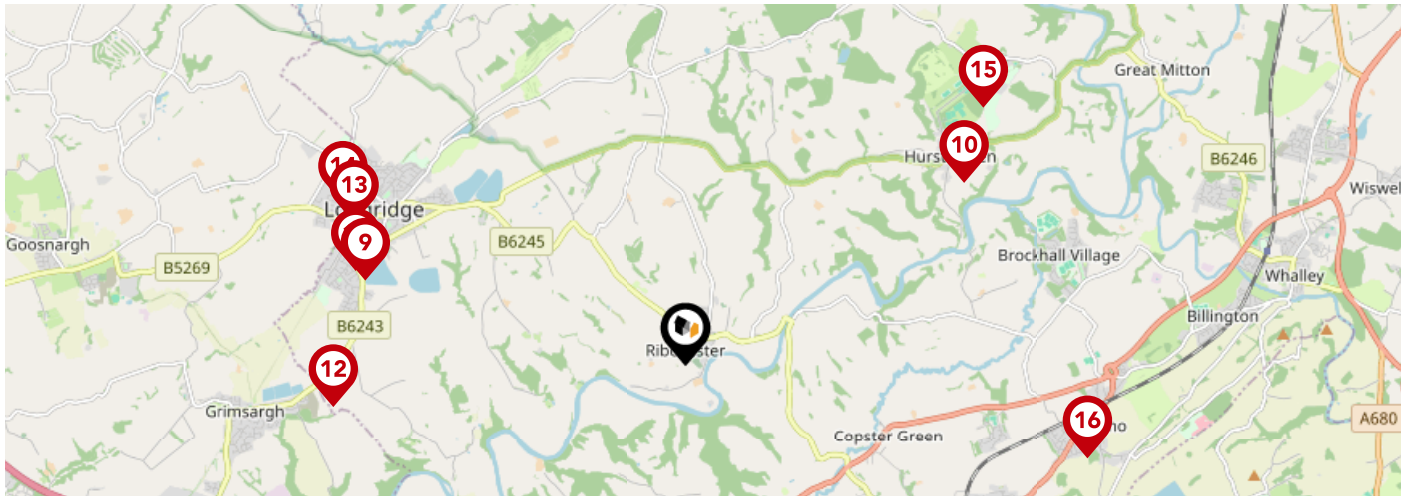

Additional EPC Data

Property Type:	House
Build Form:	Mid-Terrace
Transaction Type:	Rental (private)
Energy Tariff:	Single
Main Fuel:	Mains gas (not community)
Main Gas:	Yes
Flat Top Storey:	No
Top Storey:	0
Glazing Type:	Double glazing, unknown install date
Previous Extension:	0
Open Fireplace:	0
Ventilation:	Natural
Walls:	Cavity wall, filled cavity
Walls Energy:	Average
Roof:	Pitched, 250 mm loft insulation
Roof Energy:	Good
Main Heating:	Boiler and radiators, mains gas
Main Heating Controls:	Programmer, TRVs and bypass
Hot Water System:	From main system
Hot Water Energy Efficiency:	Good
Lighting:	Low energy lighting in 71% of fixed outlets
Floors:	Solid, no insulation (assumed)
Total Floor Area:	106 m ²



		Nursery	Primary	Secondary	College	Private
1	Ribchester St Wilfrid's Church of England Voluntary Aided Primary School Ofsted Rating: Good Pupils: 77 Distance:0.24	<input type="checkbox"/>	<input checked="" type="checkbox"/>	<input type="checkbox"/>	<input type="checkbox"/>	<input type="checkbox"/>
2	Brook View School Ofsted Rating: Good Pupils: 7 Distance:1.5	<input type="checkbox"/>	<input type="checkbox"/>	<input checked="" type="checkbox"/>	<input type="checkbox"/>	<input type="checkbox"/>
3	Hillside Specialist School and College Ofsted Rating: Good Pupils: 108 Distance:2.05	<input type="checkbox"/>	<input type="checkbox"/>	<input checked="" type="checkbox"/>	<input type="checkbox"/>	<input type="checkbox"/>
4	Salesbury Church of England Primary School Ofsted Rating: Good Pupils: 279 Distance:2.06	<input type="checkbox"/>	<input checked="" type="checkbox"/>	<input type="checkbox"/>	<input type="checkbox"/>	<input type="checkbox"/>
5	Balderstone St Leonard's Church of England Voluntary Aided Primary School Ofsted Rating: Good Pupils: 98 Distance:2.23	<input type="checkbox"/>	<input checked="" type="checkbox"/>	<input type="checkbox"/>	<input type="checkbox"/>	<input type="checkbox"/>
6	St Mary's Roman Catholic Primary School, Osbaldeston Ofsted Rating: Good Pupils: 78 Distance:2.32	<input type="checkbox"/>	<input checked="" type="checkbox"/>	<input type="checkbox"/>	<input type="checkbox"/>	<input type="checkbox"/>
7	Mellor St Mary Church of England Primary School Ofsted Rating: Good Pupils: 141 Distance:2.82	<input type="checkbox"/>	<input checked="" type="checkbox"/>	<input type="checkbox"/>	<input type="checkbox"/>	<input type="checkbox"/>
8	Longridge Church of England Primary School Ofsted Rating: Good Pupils: 195 Distance:2.89	<input type="checkbox"/>	<input checked="" type="checkbox"/>	<input type="checkbox"/>	<input type="checkbox"/>	<input type="checkbox"/>



		Nursery	Primary	Secondary	College	Private
	St Cecilia's RC High School Ofsted Rating: Good Pupils: 562 Distance:2.9	<input type="checkbox"/>	<input type="checkbox"/>	<input checked="" type="checkbox"/>	<input type="checkbox"/>	<input type="checkbox"/>
	St Joseph's Roman Catholic Primary School, Hurst Green Ofsted Rating: Good Pupils: 110 Distance:2.91	<input type="checkbox"/>	<input checked="" type="checkbox"/>	<input type="checkbox"/>	<input type="checkbox"/>	<input type="checkbox"/>
	Longridge High School Ofsted Rating: Requires improvement Pupils: 821 Distance:3.01	<input type="checkbox"/>	<input type="checkbox"/>	<input checked="" type="checkbox"/>	<input type="checkbox"/>	<input type="checkbox"/>
	Alston Lane Catholic Primary School, Longridge Ofsted Rating: Good Pupils: 241 Distance:3.11	<input type="checkbox"/>	<input checked="" type="checkbox"/>	<input type="checkbox"/>	<input type="checkbox"/>	<input type="checkbox"/>
	Longridge St Wilfrid's Roman Catholic Primary School Ofsted Rating: Good Pupils: 198 Distance:3.17	<input type="checkbox"/>	<input checked="" type="checkbox"/>	<input type="checkbox"/>	<input type="checkbox"/>	<input type="checkbox"/>
	Barnacre Road Primary School Ofsted Rating: Not Rated Pupils:0 Distance:3.32	<input type="checkbox"/>	<input checked="" type="checkbox"/>	<input type="checkbox"/>	<input type="checkbox"/>	<input type="checkbox"/>
	Stonyhurst College Ofsted Rating: Not Rated Pupils: 722 Distance:3.45	<input type="checkbox"/>	<input type="checkbox"/>	<input checked="" type="checkbox"/>	<input type="checkbox"/>	<input type="checkbox"/>
	St Mary's Roman Catholic Primary School, Langho Ofsted Rating: Good Pupils: 300 Distance:3.61	<input type="checkbox"/>	<input checked="" type="checkbox"/>	<input type="checkbox"/>	<input type="checkbox"/>	<input type="checkbox"/>

Area

Transport (National)

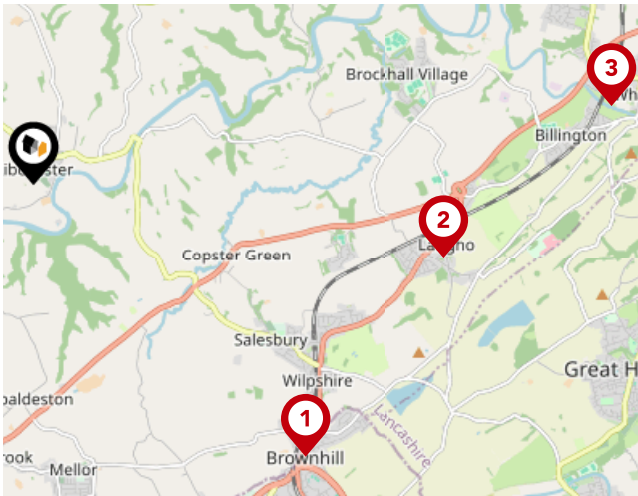

National Rail Stations

Pin	Name	Distance
1	Ramsgreave & Wilpshire Rail Station	3.38 miles
2	Langho Rail Station	3.64 miles
3	Whalley Rail Station	5.11 miles

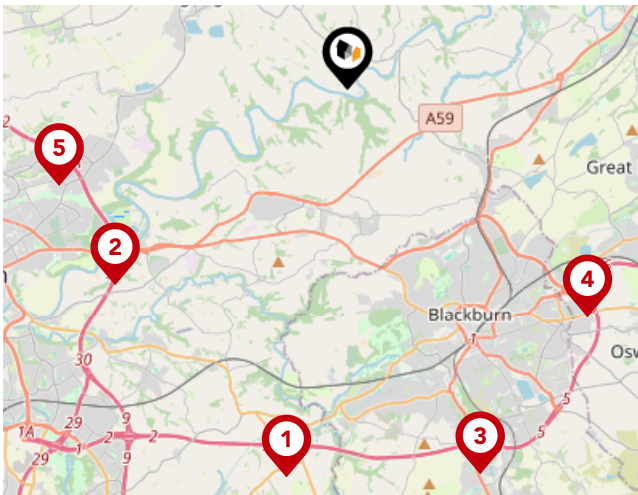

Trunk Roads/Motorways

Pin	Name	Distance
1	M65 J3	6.88 miles
2	M6 J31	5.32 miles
3	M65 J4	7.14 miles
4	M65 J6	5.79 miles
5	M6 J31A	5.32 miles

Area

Transport (Local)

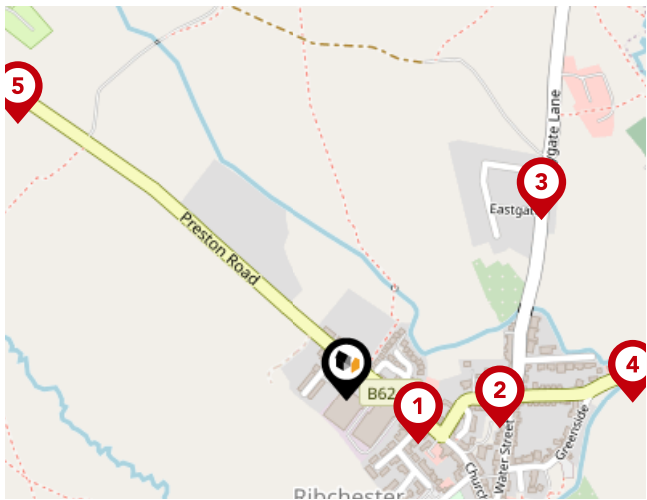

Bus Stops/Stations

Pin	Name	Distance
1	Black Bull	0.09 miles
2	Post Office	0.17 miles
3	Stoneygate Lane	0.29 miles
4	Ribchester Arms	0.31 miles
5	Kitchen Grn Fm	0.47 miles

Market

House Price Statistics

10 Year History of Average House Prices by Property Type in PR3

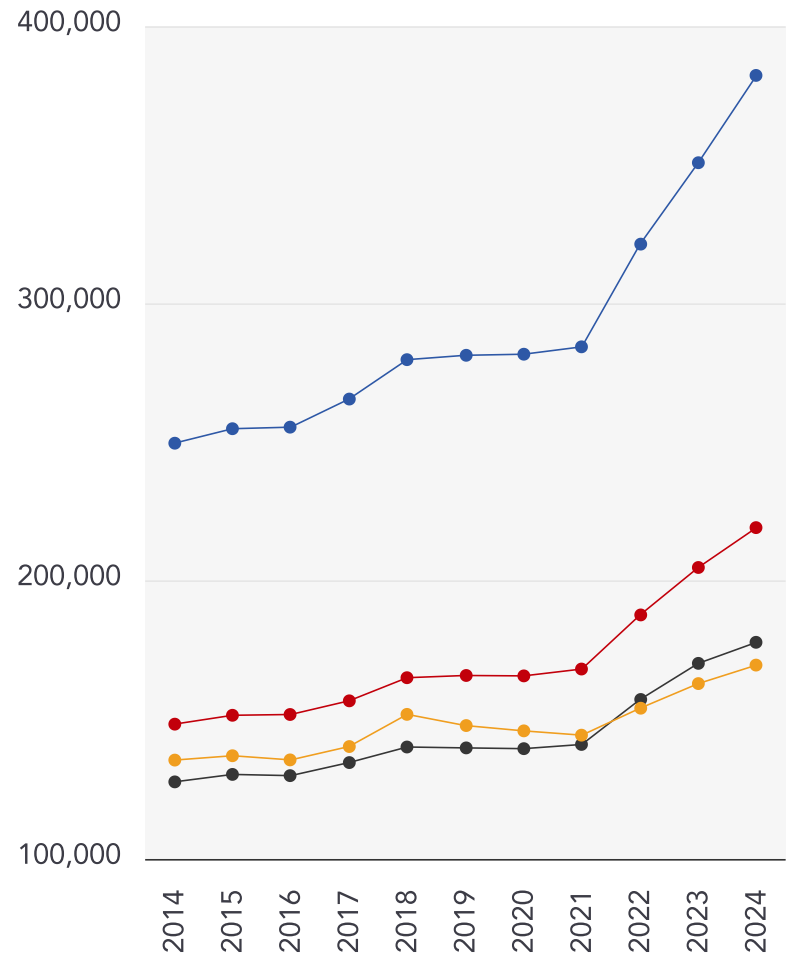

Detached

+53.05%

Semi-Detached

+47.66%

Flat

+25.24%

Terraced

+39.35%



Pendle Hill Properties

If you are looking for exceptional service, high level sales skills and a team driven by success look no further than Pendle Hill Properties.

At Pendle Hill Properties we pride ourselves on offering the very best personal service and help buyers, sellers, landlords and tenants alike achieve their aims.

From the very first moment you call us you will feel secure in the knowledge that you are in safe and reliable hands. We take away the stress of property selection and buying and make the whole process simple and painless. Not only that but we have access to a team of partners who can provide legal, mortgage and financial advice, surveys, and provide a range of products tailored to your needs. In short Pendle Hill Properties is your one stop property shop.

Testimonial 1



A super big Thank you to Andrew and all the team at Pendle Hill Properties for selling my house quickly. The service and communication from this company was second to none. Highly recommended. 5 star review from me.

Testimonial 2



Moved to Pendle Hill properties after a really poor experience with a previous agent and immediately saw a difference from the photographs and marketing, to the number of viewings. Andrew worked hard to get our sale to completion and was always contactable for any queries. Would recommend.

Testimonial 3



We used Pendle Properties to both sell our home, and rent our new home. It's a family-run company, and that really comes over in the service. You get that personal touch that is so often missing from high street estate agents. They care about their service. Our property in Cliviger was advertised and sold within 10 weeks, thanks to some great promotion across all platforms. They are strong and creative on social media. All in all, we'd highly recommend!

Testimonial 4



Hi, So Andrew and Thomas took on a very niche house. They were aligned with the way I wanted to house marketed right from the offset. Always available to contact even out of work hours. Due diligence on buyers made to a high level. A very personal approach to dealing with buyers and vendors. Succeeded in the sale of our house. Recommended their services. Thanks



/PendleHillProperties/



/pendlehillproperties/



/PendleHillProps



/company/pendle-hill-properties/

Pendle Hill Properties

Data Quality

We are committed to comprehensive property data being made available upfront to make the home buying and selling process quicker, easier and cheaper. This is why we have partnered with Sprift, the UK's leading supplier of property-specific data.



Contains public sector information licensed under the Open Government License v3.0

The information contained within this report is for general information purposes only and to act as a guide to the best way to market your property for the asking price.

Sprift Technologies Ltd aggregate this data from a wide variety of sources and while we endeavour to keep the information up to date and correct, we make no representations or warranties of any kind, express or implied, about the completeness, accuracy, reliability, of the information or related graphics contained within this report for any purpose.

Any reliance you place on such information is therefore strictly at your own risk. In no event will we be liable for any loss or damage including without limitation, indirect or consequential loss or damage, or any loss or damage whatsoever arising from loss of data or profits arising out of, or in connection with, the use of this report.



Pendle Hill Properties

154 Whalley Road Read BB12 7PN

01282 772048

andrew@pendlehillproperties.co.uk

www.pendlehillproperties.co.uk



Valuation Office
Agency

