



See More Online

# KFB: Key Facts For Buyers

A Guide to This Property & the Local Area

**Friday 01<sup>st</sup> August 2025**

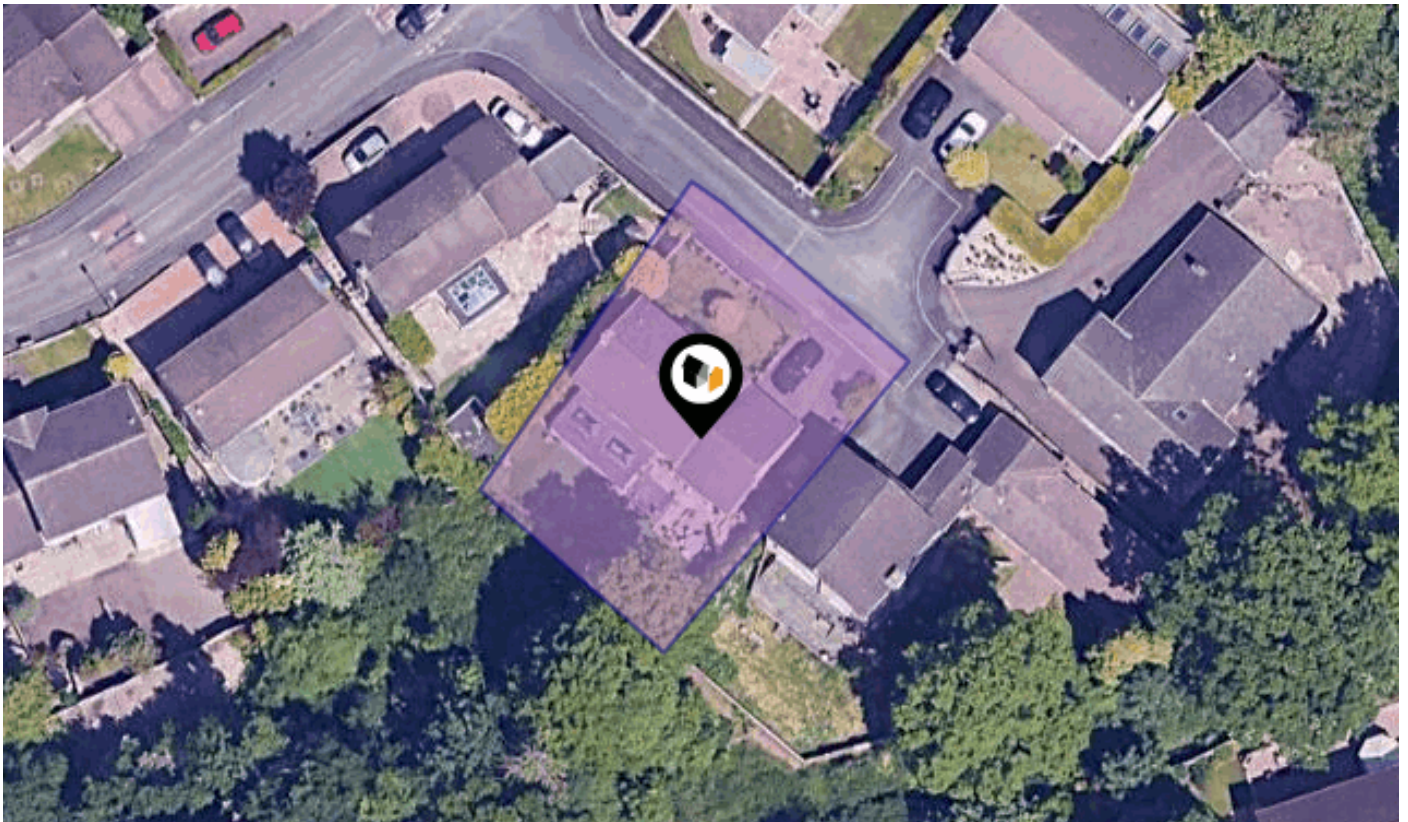

**PATTERDALE CLOSE, BURNLEY, BB10**

## Pendle Hill Properties

154 Whalley Road Read BB12 7PN

01282 772048

india@pendlehillproperties.co.uk

www.pendlehillproperties.co.uk





## Property

Type:	Detached	Tenure:	Freehold
Bedrooms:	4		
Floor Area:	2,478 ft <sup>2</sup> / 230 m <sup>2</sup>		
Plot Area:	0.16 acres		
Council Tax :	Band F		
Annual Estimate:	£3,662		
Title Number:	LA666007		

## Local Area

Local Authority:	Lancashire	Estimated Broadband Speeds	
Conservation Area:	No	(Standard - Superfast - Ultrafast)	
Flood Risk:			
● Rivers & Seas	Very low	28	1000
● Surface Water	Very low	mb/s	mb/s

Mobile Coverage:	Satellite/Fibre TV Availability:		
(based on calls indoors)			





## PATTERDALE CLOSE, BURNLEY, BB10

### Ground Floor

Approx. 153.6 sq. metres (1653.8 sq. feet)

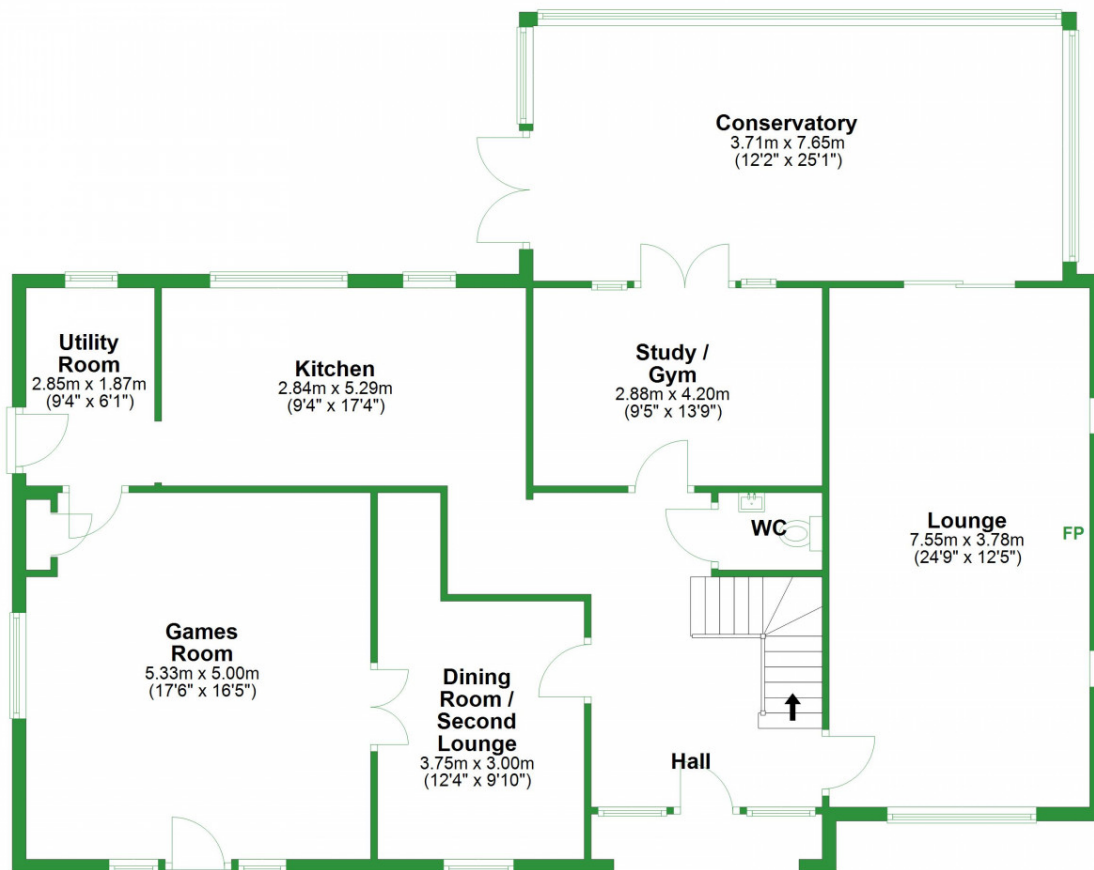

Total area: approx. 230.3 sq. metres (2478.6 sq. feet)

**PATTERDALE CLOSE, BURNLEY, BB10**

**First Floor**

Approx. 76.6 sq. metres (824.8 sq. feet)

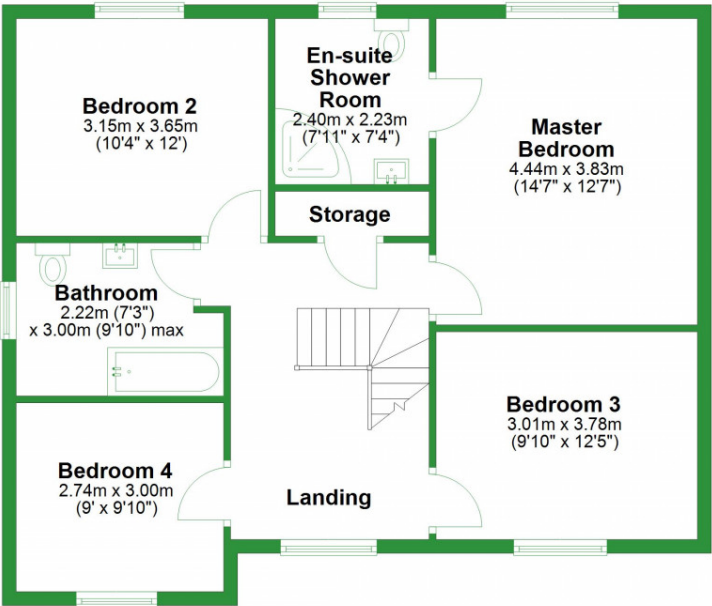

# Market

## House Price Statistics

10 Year History of Average House Prices by Property Type in BB10

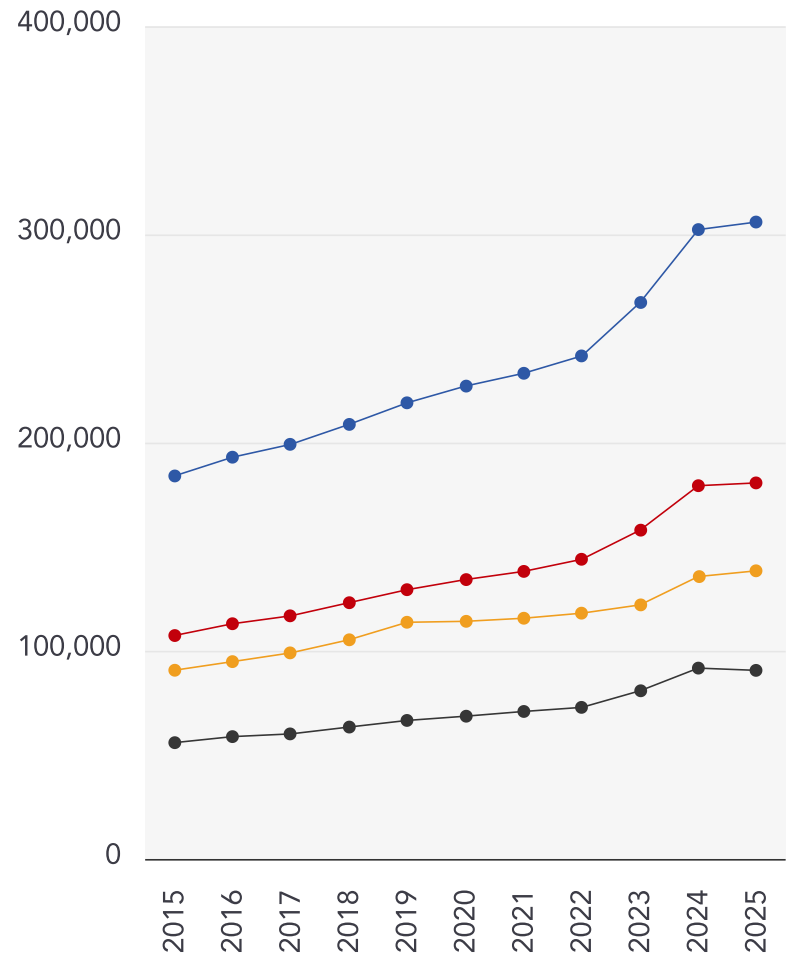

Detached

**+66.29%**

Semi-Detached

**+68.31%**

Flat

**+52.7%**

Terraced





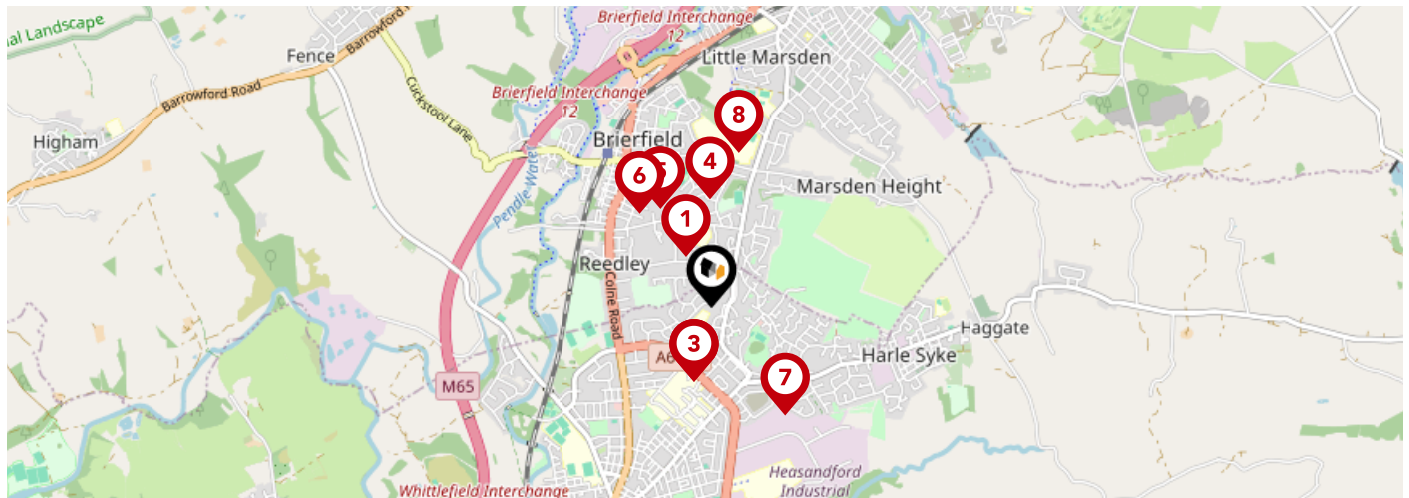

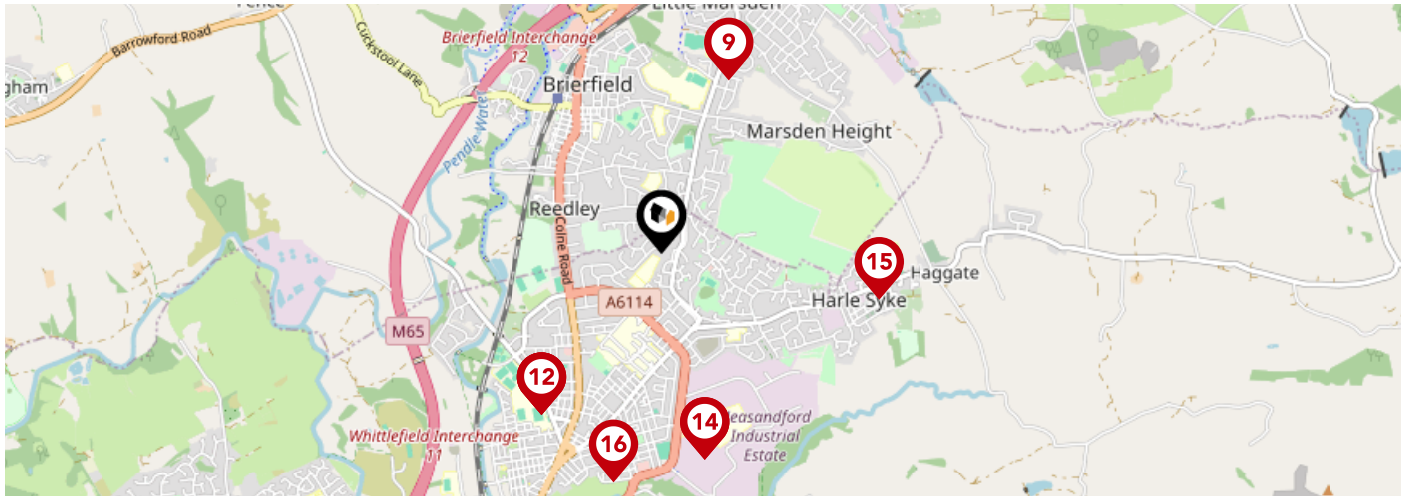

**+62.15%**





		Nursery	Primary	Secondary	College	Private
<b>1</b>	<b>Reedley Primary School</b> Ofsted Rating: Good   Pupils: 409   Distance:0.25	<input type="checkbox"/>	<input checked="" type="checkbox"/>	<input type="checkbox"/>	<input type="checkbox"/>	<input type="checkbox"/>
<b>2</b>	<b>Casterton Primary Academy</b> Ofsted Rating: Good   Pupils: 297   Distance:0.33	<input type="checkbox"/>	<input checked="" type="checkbox"/>	<input type="checkbox"/>	<input type="checkbox"/>	<input type="checkbox"/>
<b>3</b>	<b>St John the Baptist RC Primary School, a Voluntary Academy</b> Ofsted Rating: Good   Pupils: 214   Distance:0.33	<input type="checkbox"/>	<input checked="" type="checkbox"/>	<input type="checkbox"/>	<input type="checkbox"/>	<input type="checkbox"/>
<b>4</b>	<b>Holy Trinity Roman Catholic Primary School, a Voluntary Academy</b> Ofsted Rating: Good   Pupils: 116   Distance:0.48	<input type="checkbox"/>	<input checked="" type="checkbox"/>	<input type="checkbox"/>	<input type="checkbox"/>	<input type="checkbox"/>
<b>5</b>	<b>Woodfield Nursery School</b> Ofsted Rating: Good   Pupils: 119   Distance:0.49	<input checked="" type="checkbox"/>	<input type="checkbox"/>	<input type="checkbox"/>	<input type="checkbox"/>	<input type="checkbox"/>
<b>6</b>	<b>Pendle Primary Academy</b> Ofsted Rating: Good   Pupils: 412   Distance:0.52	<input type="checkbox"/>	<input checked="" type="checkbox"/>	<input type="checkbox"/>	<input type="checkbox"/>	<input type="checkbox"/>
<b>7</b>	<b>St James' Lanehead Church of England Primary School</b> Ofsted Rating: Good   Pupils: 280   Distance:0.57	<input type="checkbox"/>	<input checked="" type="checkbox"/>	<input type="checkbox"/>	<input type="checkbox"/>	<input type="checkbox"/>
<b>8</b>	<b>Marsden Heights Community College</b> Ofsted Rating: Good   Pupils: 1037   Distance:0.69	<input type="checkbox"/>	<input type="checkbox"/>	<input checked="" type="checkbox"/>	<input type="checkbox"/>	<input type="checkbox"/>



		Nursery	Primary	Secondary	College	Private
	<b>Nelson St Paul's Church of England Primary School</b> Ofsted Rating: Good   Pupils: 407   Distance:0.82	<input type="checkbox"/>	<input checked="" type="checkbox"/>	<input type="checkbox"/>	<input type="checkbox"/>	<input type="checkbox"/>
	<b>Reedley Hallows Nursery School</b> Ofsted Rating: Outstanding   Pupils: 176   Distance:0.88	<input checked="" type="checkbox"/>	<input type="checkbox"/>	<input type="checkbox"/>	<input type="checkbox"/>	<input type="checkbox"/>
	<b>Holly Grove School</b> Ofsted Rating: Outstanding   Pupils: 121   Distance:0.88	<input type="checkbox"/>	<input checked="" type="checkbox"/>	<input type="checkbox"/>	<input type="checkbox"/>	<input type="checkbox"/>
	<b>Barden Primary School</b> Ofsted Rating: Good   Pupils: 476   Distance:0.88	<input type="checkbox"/>	<input checked="" type="checkbox"/>	<input type="checkbox"/>	<input type="checkbox"/>	<input type="checkbox"/>
	<b>Ridgewood Community High School</b> Ofsted Rating: Good   Pupils: 186   Distance:0.92	<input type="checkbox"/>	<input type="checkbox"/>	<input checked="" type="checkbox"/>	<input type="checkbox"/>	<input type="checkbox"/>
	<b>Sir John Thursby Community College</b> Ofsted Rating: Good   Pupils: 1117   Distance:0.92	<input type="checkbox"/>	<input type="checkbox"/>	<input checked="" type="checkbox"/>	<input type="checkbox"/>	<input type="checkbox"/>
	<b>Briercliffe Primary School</b> Ofsted Rating: Requires improvement   Pupils: 396   Distance:0.98	<input type="checkbox"/>	<input checked="" type="checkbox"/>	<input type="checkbox"/>	<input type="checkbox"/>	<input type="checkbox"/>
	<b>Heasandford Primary School</b> Ofsted Rating: Good   Pupils: 630   Distance:1.02	<input type="checkbox"/>	<input checked="" type="checkbox"/>	<input type="checkbox"/>	<input type="checkbox"/>	<input type="checkbox"/>



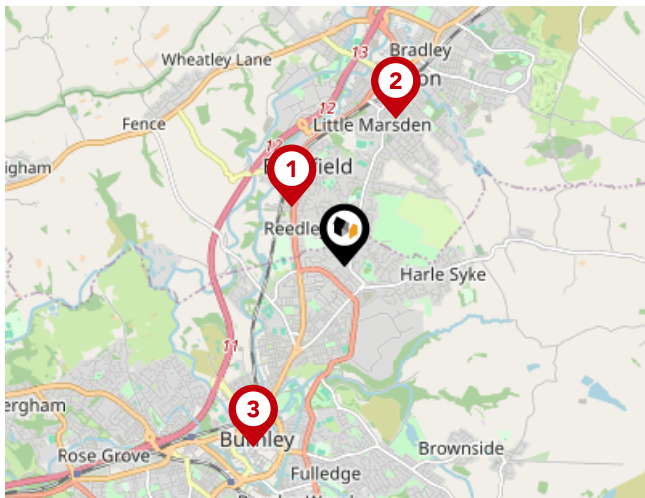

# Area

## Transport (National)





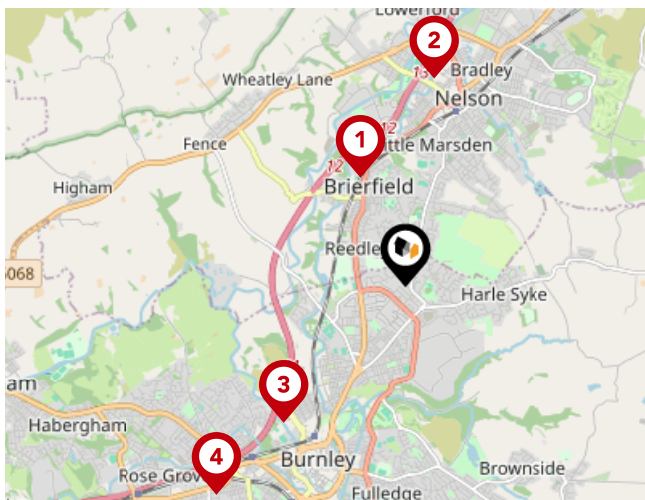

### National Rail Stations

Pin	Name	Distance
	Brierfield Rail Station	0.69 miles
	Nelson Rail Station	1.37 miles
	Burnley Central Rail Station	1.79 miles



### Trunk Roads/Motorways

Pin	Name	Distance
	M65 J12	1.03 miles
	M65 J13	1.83 miles
	M65 J11	1.61 miles
	M65 J10	2.46 miles
	M65 J14	2.93 miles

# Area

## Transport (Local)

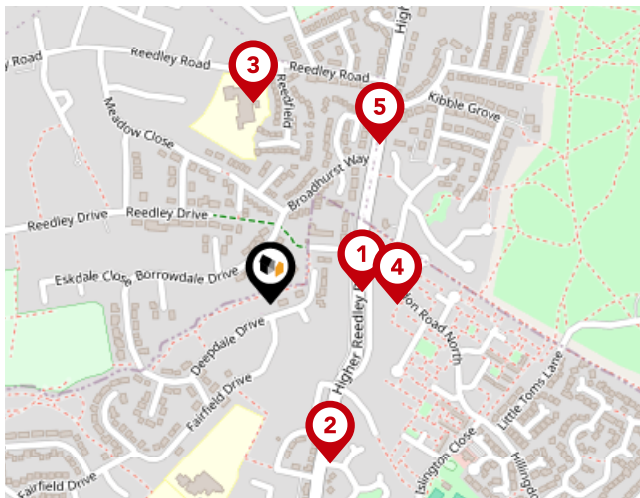

### Bus Stops/Stations

Pin	Name	Distance
1	Hillingdon Road North	0.1 miles
2	Kibble Crescent	0.19 miles
3	Primary School	0.22 miles
4	Chislehurst Grove	0.14 miles
5	Moorland Drive	0.21 miles

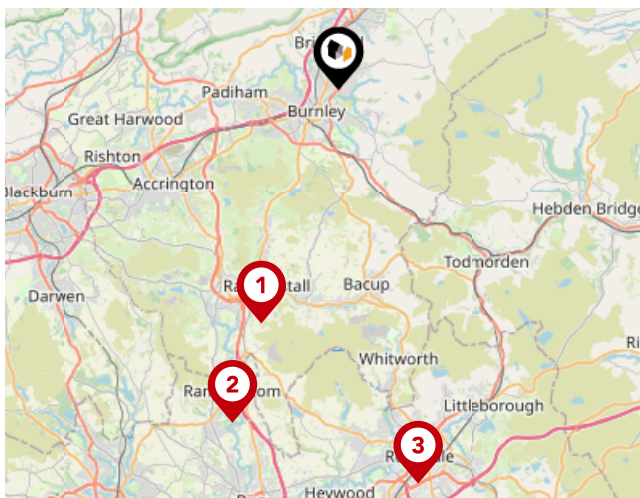

### Local Connections

Pin	Name	Distance
1	Rawtenstall (East Lancashire Railway)	8.59 miles
2	Ramsbottom (East Lancashire Railway)	12.24 miles
3	Rochdale Interchange (Manchester Metrolink)	14.07 miles



### **Pendle Hill Properties**

---

If you are looking for exceptional service, high level sales skills and a team driven by success look no further than Pendle Hill Properties.

At Pendle Hill Properties we pride ourselves on offering the very best personal service and help buyers, sellers, landlords and tenants alike achieve their aims.

From the very first moment you call us you will feel secure in the knowledge that you are in safe and reliable hands. We take away the stress of property selection and buying and make the whole process simple and painless. Not only that but we have access to a team of partners who can provide legal, mortgage and financial advice, surveys, and provide a range of products tailored to your needs. In short Pendle Hill Properties is your one stop property shop.

### Testimonial 1



A super big Thank you to Andrew and all the team at Pendle Hill Properties for selling my house quickly. The service and communication from this company was second to none. Highly recommended. 5 star review from me.

### Testimonial 2



Moved to Pendle Hill properties after a really poor experience with a previous agent and immediately saw a difference from the photographs and marketing, to the number of viewings. Andrew worked hard to get our sale to completion and was always contactable for any queries. Would recommend.

### Testimonial 3



We used Pendle Properties to both sell our home, and rent our new home. It's a family-run company, and that really comes over in the service. You get that personal touch that is so often missing from high street estate agents. They care about their service. Our property in Cliviger was advertised and sold within 10 weeks, thanks to some great promotion across all platforms. They are strong and creative on social media. All in all, we'd highly recommend!

### Testimonial 4



Hi, So Andrew and Thomas took on a very niche house. They were aligned with the way I wanted to house marketed right from the offset. Always available to contact even out of work hours. Due diligence on buyers made to a high level. A very personal approach to dealing with buyers and vendors. Succeeded in the sale of our house. Recommended their services. Thanks



/PendleHillProperties/



/pendlehillproperties/



/PendleHillProps



/company/pendle-hill-properties/



# Pendle Hill Properties

## Data Quality

We are committed to comprehensive property data being made available upfront to make the home buying and selling process quicker, easier and cheaper. This is why we have partnered with Sprift, the UK's leading supplier of property-specific data.



### Contains public sector information licensed under the Open Government License v3.0

The information contained within this report is for general information purposes only.

Sprift Technologies Ltd aggregate this data from a wide variety of sources and while we endeavour to keep the information up to date and correct, we make no representations or warranties of any kind, express or implied, about the completeness, accuracy, reliability, of the information or related graphics contained within this report for any purpose.

Any reliance you place on such information is therefore strictly at your own risk. In no event will we be liable for any loss or damage including without limitation, indirect or consequential loss or damage, or any loss or damage whatsoever arising from loss of data or profits arising out of, or in connection with, the use of this report.



#### Pendle Hill Properties

154 Whalley Road Read BB12 7PN

01282 772048

india@pendlehillproperties.co.uk

www.pendlehillproperties.co.uk

