



Westbourne Villas, Hove, BN3
£400,000-£425,000

ASTON
VAUGHAN
Sales and Lettings

INTRODUCING

Westbourne Villas, BN3

2 Bedrooms | 1 Bathrooms | 1 Living Room
823 Sq Ft | New Church Road area

Westbourne Villas is one of the widest roads leading down to the sea in Central Hove, giving it an air of grandeur. The beaches of Hove are among the cleanest on the South Coast, offering space for summer picnics, sea swimming and exercise space for local residents.

This recently redecorated apartment sits within a substantial townhouse, set well back from the road behind a neat and scented front garden. The house bears the architectural features of the era with a long path leading to a Corinthian portico entrance opening to the communal hallway where your door sits to the right.

Stepping inside, the flat feels bright and airy with your eye immediately drawn to the living room spanning the front of the house with a wide bay window stretching up to the high ceiling bringing in plenty of natural light from the east. Many original features have been retained within the deep skirting boards, picture rails and cornicing, while the decoration is fresh and airy with white walls and new dove-grey carpet. There is ample space in here for relaxed seating and formal dining, or indeed, working from home.

- Ground floor garden apartment
- 2 double bedrooms
- Newly decorated and carpeted
- West facing rear garden
- Very close to Hove Seafront and Lawns
- Excellent transport links

This modern, neutral decoration flows through the property into both double bedrooms, one sitting centrally to the flat with garden views and the second to the rear of the flat with direct garden access. Both rooms are great sizes for professional sharers or those looking for a peaceful home office. Both bedrooms have easy access to the bathroom which has been modernised with a gleaming white bath suite lined with marbled white and grey wall panels.

Streamlined and stylish, the kitchen has been well-designed with handle-free cabinetry in white, paired with solid oak worktops and patterned vinyl flooring bringing both form and function to the space. Some appliances have been integrated, leaving space for others, and grey brick-tile splashbacks complete the scheme.

Outside, the garden is joyful with an area of lawn and a decked space for drinks and dining alfresco. The borders are fragrant and mature with neighbouring trees providing privacy and dappled shade from the westerly sunshine. The garden receives the sun until it sets late in the summer, ideal for balmy summer evenings with friends.



Virtually Staged



Virtually Staged



Virtually Staged



Virtually Staged



LOCATION GUIDE

Good to Know

Shops: Local 5 min walk, city centre 10 min bus ride

Train Station: Aldrington Station 5-7 min walk, Hove Station 20 min walk

Seafront or Park: Hove Lawns and seafront 1 min walk

Education

Primary: West Hove, St Andrew's

Secondary: Hove Park, Blatchington Mill, Cardinal Newman

Sixth Form: Varndean, BIMM, City College

Private: Brighton College, St Christopher's

This is a wonderfully sunny apartment in a popular location which is well served for shops, the beach, parks and schools. There are plenty of local green spaces, and great transport links, but you are also only a short walk from everything this vibrant coastal city has to offer. It is also within easy walking distance of both Aldrington and Hove Stations, and the cafes, gastropubs and bars of Poets Corner and Church Road, so it will suit professionals, commuters and investors alike.

Westbourne Villas

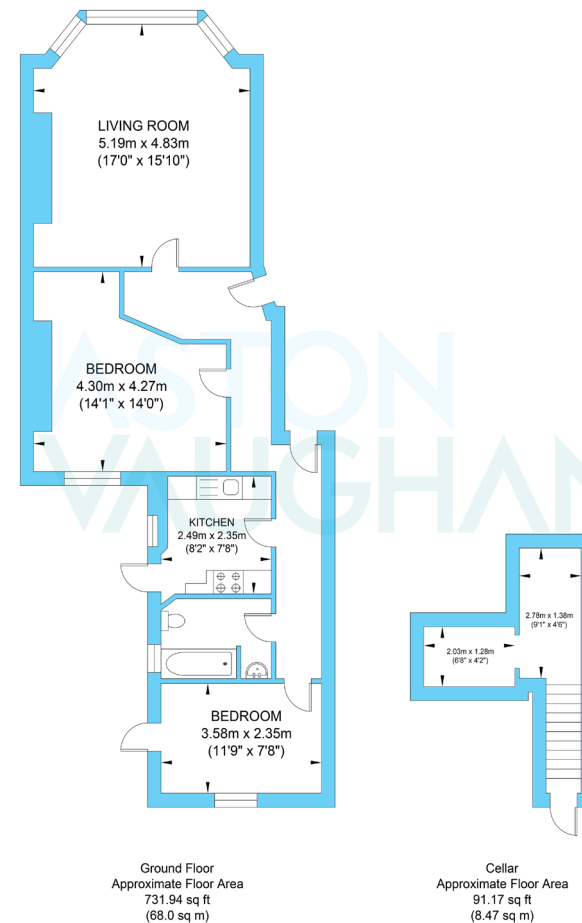

Approximate Gross Internal Area = 76.47 sq m / 823.11 sq ft

Illustration for identification purposes only, measurements are approximate, not to scale.