



Boulevard House, Regent Street, Brighton, BN1 1UU

Asking Price £385,000

Boulevard House, Regent Street, Brighton, BN1 1UU

Superbly presented, spacious second floor apartment located in the North Laine conservation area in the heart of the city centre.

The spacious (18' x 18') open plan living area has a modern white fronted fitted kitchen with integrated appliances and island unit/breakfast bar, space for a table and chairs and a sitting/TV area. The double glazed windows provide interesting leafy views across Jubilee square. The principal bedroom has a range of built in wardrobes, large double glazed windows and an en-suite shower room. The second bedroom is also a good size and has a range of built in wardrobes. There is also a family bathroom off the central hallway. The property is very well insulated and benefits from a 'B' energy efficiency rating. There is access to a secure undercover bike store on the ground floor.

Regent Street is located in the vibrant North Laine conservation area, in central Brighton. This superb location benefits from a variety of amenities right on the proverbial doorstep, such as local cafes, boutiques, bars, pubs, high street shopping and entertainment facilities. Brighton Dome (0.1 miles), Brighton Komedia (0.1 miles), Churchill Square Shopping Centre (0.4 miles), Brighton Seafront & Brighton Palace Pier (0.6 miles), Brighton Mainline Railway Station (0.4 miles), Waitrose supermarket (0.7 miles), Sainsburys supermarket (0.4 miles), Theatre Royal (0.1 miles).



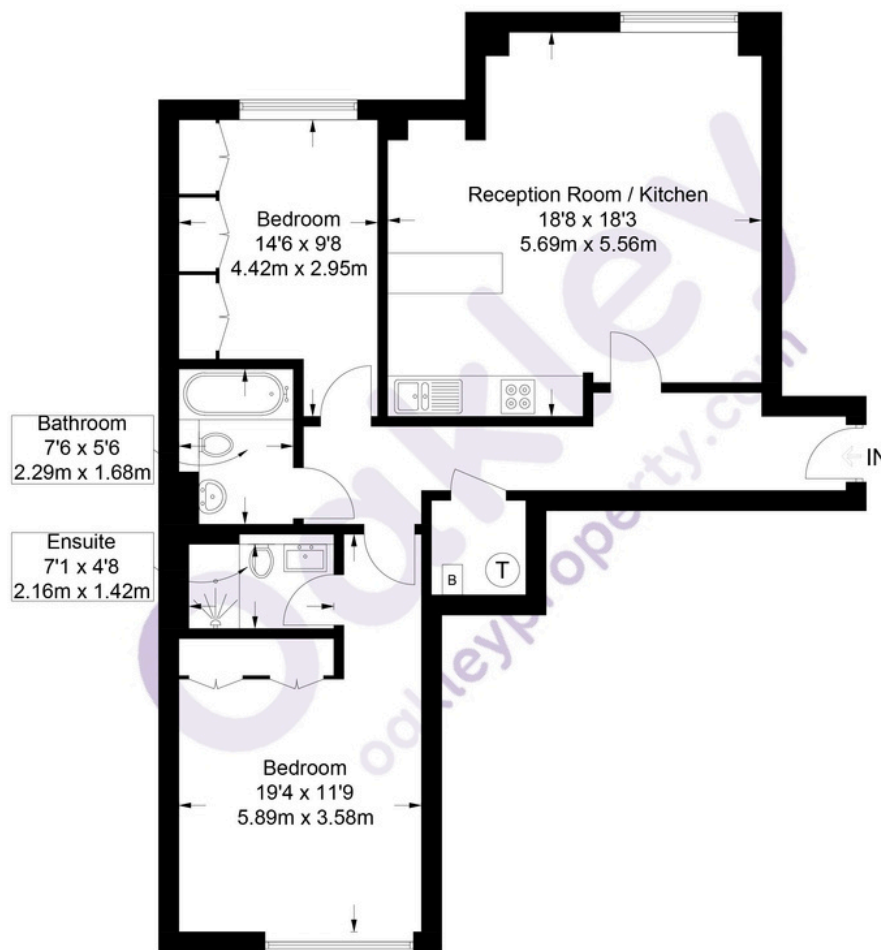

Second Floor

Approximate Gross Internal Area = 866 sq ft / 80.5 sq m

Illustration for identification purposes only,
measurements are approximate, not to scale. © Oakley Property 2022

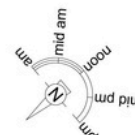

Agents Notes

Leasehold
128 Year Lease Remaining
Service Charge Approx £2,734.04 Per Annum
Ground Rent N/A
Council Tax Band D

Energy Performance Certificate

Score	Energy rating	Current	Potential
92+	A		
81-91	B	83 B	94 A
69-80	C		
55-68	D		
39-54	E		
21-38	F		
1-20	G		



Please note:

These details have been produced in good faith and are believed to be accurate based upon the information supplied but they are not intended to form part of a contract. All statements contained in these particulars as to this property are made without responsibility on the part of Oakley, the vendors or lessors and are NOT to be relied on as statements or representations of fact. Any intending purchasers must satisfy themselves by inspection or otherwise as to the correctness of each of the statements contained in these particulars. The vendors, Oakley and any person who work in their employment do not have any authority to make or give any representation or warranty. The floor plan is for illustrative purposes only and the accuracy cannot be relied upon or guaranteed and no responsibility is taken for an error, omission or mis-statement. The total floor area shown has been taken from the EPC.



Oakley

Your Sussex Property Expert

Brighton & Hove Office

01273 688 881

3-6 North Road, Brighton BN1 1YA

www.oakleyproperty.com

brighton@oakleyproperty.com

We also have offices in:

Shoreham by Sea

Lewes Town & Country

The London Office



A new way of marketing property

Get in touch to book a viewing or valuation of
your own property

