



South House, Queens Place, BN43 5AA
Guide Price £475,000

South House, Queens Place, BN43 5AA

The Property & Area

Located in the highly sought-after Queens Place in Shoreham-By-Sea, this three-bedroom townhouse offers an exceptional opportunity for buyers seeking modern living combined with a convenient location. Perfectly positioned just a short distance from Shoreham train station and the lively town centre, this property provides excellent transport links and amenities within easy reach.

The ground floor features a versatile hobby room or office, ideal for those working from home or looking for additional recreational space. This room provides flexibility to adapt to your needs, whether as a workspace, DJ room, or playroom. There is also a ground floor shower room and bedroom 3, which has access to the sunny courtyard garden.

The main living area lies on the first floor, with a generously proportioned lounge. The lounge is accentuated by a large bay window, allowing natural light to flood the space and offering views over the surrounding area. Its size ensures ample room for comfortable seating, making it a perfect spot for relaxation or entertaining.

The adjacent kitchen is practical and well designed, featuring ample storage. The property has three well-sized bedrooms, each offering comfortable spaces. The principal bedroom and 2nd bedroom share a bathroom on the top floor. All bedrooms are bright, well-presented, and finished to a good standard.

The outdoor space includes a private courtyard garden, ideal for al fresco style dining, gardening, or simply enjoying a peaceful space. The low maintenance design ensures you can enjoy the garden without heavy upkeep.

The property is complete with a garage and off-road parking, a significant advantage in this central location. The garage has been part converted to create the hobby room and provide storage space.

Queens Place is a highly desirable address in Shoreham-By-Sea, offering a blend of town living with a community feel. Its proximity to the train station makes it ideal for commuters, with direct links to Brighton, London, and beyond. Additionally, the nearby town centre provides an assortment of shops, cafés, and restaurants. Shoreham is a fantastic town to wander around!

This modern townhouse combines spacious living areas with practical features and a superb location. Whether you are a growing family, a professional couple, or someone looking to downsize without compromising on lifestyle, this property is worth a look.

Material Information:

Tenure: Freehold

Council tax: D



Floorplan

Queens Place, Shoreham-by-Sea

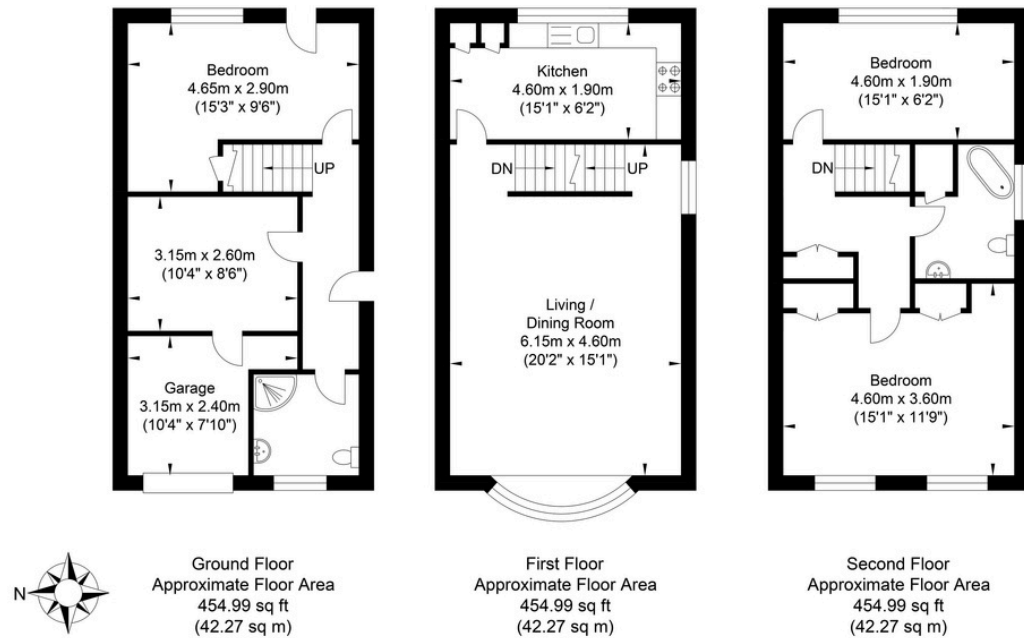

Energy Performance Certificate



Oakley

Your Sussex Property Expert

Shoreham Property Hub

01273 661 577

6 Brunswick Road, Shoreham BN43 5WB

www.oakleyproperty.com

shoreham@oakleyproperty.com

We also have offices in:

Lewes

Brighton & Hove

Property Video

Get in touch to book a viewing or valuation of your own property



Please note:

These details have been produced in good faith and are believed to be accurate based upon the information supplied but they are not intended to form part of a contract. All statements contained in these particulars as to this property are made without responsibility on the part of Oakley, the vendors or lessors and are NOT to be relied on as statements or representations of fact. Any intending purchasers must satisfy themselves by inspection or otherwise as to the correctness of each of the statements contained in these particulars. The vendors, Oakley and any person who work in their employment do not have any authority to make or give any representation or warranty. The floor plan is for illustrative purposes only and the accuracy cannot be relied upon or guaranteed and no responsibility is taken for an error, omission or mis-statement. The total floor area shown has been taken from the EPC.