



PUTTERILLS

est. 1992

Guide Price £550,000

West Mead, Welwyn Garden City, AL7 4SA

PROPERTY SUMMARY

A well-presented semi-detached home tucked into a quiet cul-de-sac in the sought-after West Mead in Welwyn Garden City. With off-road parking, a garage, a large garden, and genuine scope to extend.

The ground floor offers two versatile reception rooms, including a dining room extension that brings in excellent natural light and creates a sociable, open feel. The kitchen is bright and well-equipped for everyday use.

Upstairs, three well-proportioned bedrooms offer comfortable, peaceful accommodation — plenty of space for a growing family or to set up a home office. A family bathroom serves all three rooms, fitted to a good standard and well-maintained throughout.

The large private garden is one of this home's standout features. Generous in size, it's well-suited to children playing, keen gardeners, or simply relaxing and entertaining when the weather allows. It also lends itself nicely to a future extension, should a new owner wish to grow the ground floor footprint — subject to the usual planning consents.

A garage with off road parking is located just around the corner, along with local shops covering everyday essentials, well-regarded schools within easy reach, and the cul-de-sac setting means minimal through traffic. Transport links are conveniently close for commuters too.



















LOCAL AUTHORITY
Welwyn Hatfield

TENURE
Freehold

COUNCIL TAX BAND
D

VIEWINGS
By prior appointment only

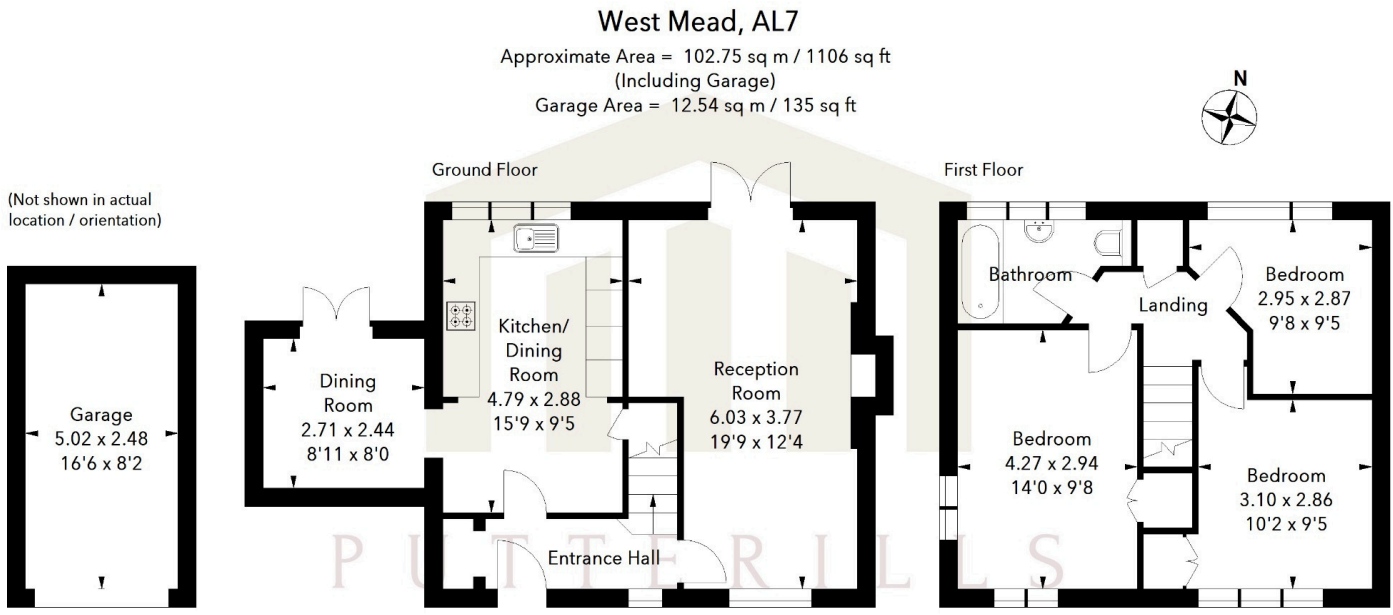

EST. 1992
Illustration For Identification Purposes Only.
All measurements and areas are approximate, not to scale.
© Orange Tree Photography

Score	Energy rating	Current	Potential
92+	A		
81-91	B		
69-80	C	72 C	78 C
55-68	D		
39-54	E		
21-38	F		
1-20	G		

Agents Note: Whilst every care has been taken to prepare these particulars, they are for guidance purposes only. All measurements are approximate and are for general guidance purposes only and whilst every care has been taken to ensure their accuracy, they should not be relied upon and potential buyers/tenants are advised to recheck the measurements



OFFICE ADDRESS
Putterills Welwyn
Garden City
34 Wigmores North,
Hertfordshire, AL8 6PH

CONTACT DETAILS

01707 393333
wgc@putterills.co.uk
www.putterills.co.uk