



P U T T E R I L L S

— est. 1992 —



High Street, Whitwell, Hitchin, SG4 8AJ

Guide Price: £450,000

## PROPERTY SUMMARY

Having been lovingly cared for by the same family for 46 years, this charming Whitwell home is now ready for its next chapter as the current owners relocate to be closer to their children and family. Thoughtfully extended over the years, the property has been at the heart of family life, with its open-plan kitchen, conservatory and beautiful countryside garden creating a lifestyle centred around comfort, community and the outdoors. Set within one of Hertfordshire's most picturesque villages, it offers a rare opportunity to enjoy peaceful village living with excellent access to Hitchin, Harpenden and highly regarded schools.

3



2



1













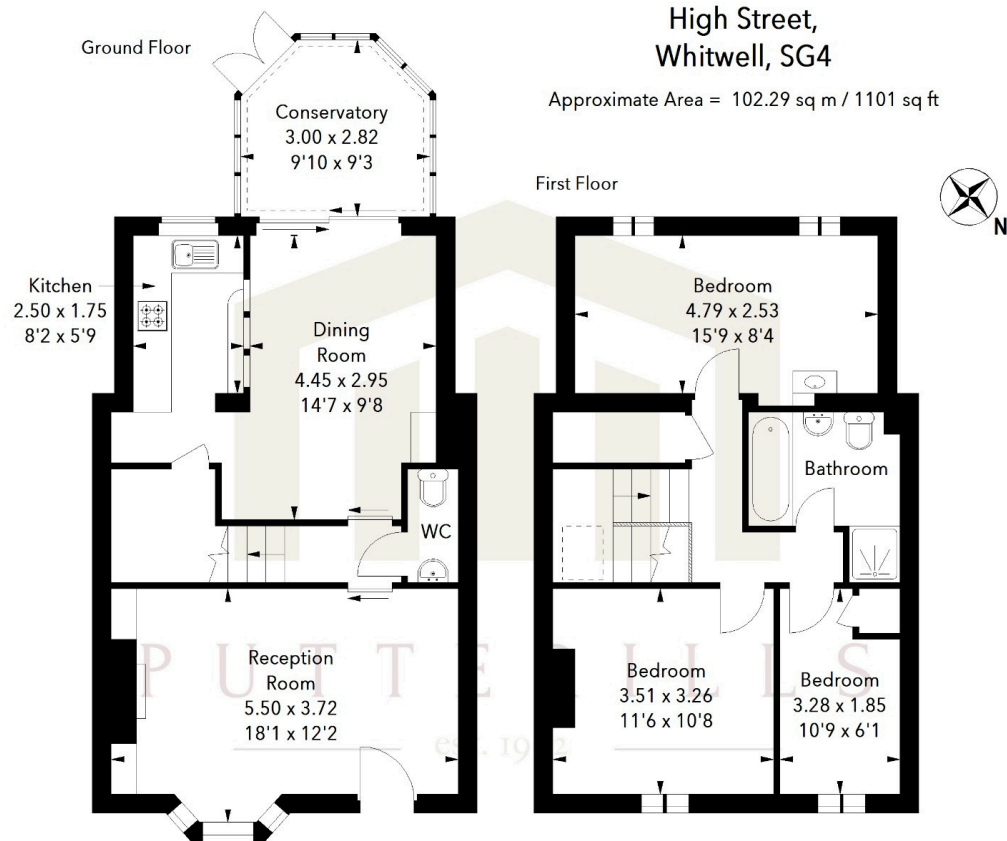

Illustration For Identification Purposes Only.  
All measurements and areas are approximate, not to scale.  
© Orange Tree Photography

**LOCAL AUTHORITY**  
North Herts

**TENURE**  
Freehold

**COUNCIL TAX BAND**  
E

**VIEWINGS**  
By prior appointment only

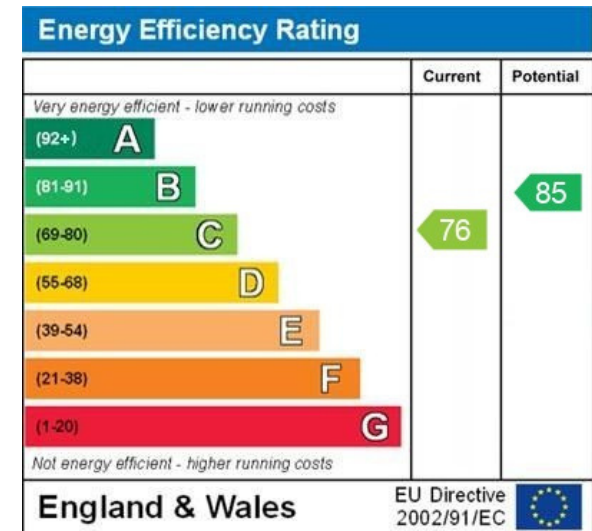

WWW.EPC4U.COM



**OFFICE ADDRESS**

Putterills Hitchin  
60 Hermitage Road  
Hitchin  
SG5 1DB

**CONTACT DETAILS**

01462 632222  
hitchin@putterills.co.uk  
www.putterills.co.uk