



PUTTERILLS

— est. 1992 —



Blakemere Road, Welwyn Garden City, AL8 7PJ

Guide Price: £850,000

# Property Summary

4 

1 

2 

Situated in one of Welwyn Garden City's most sought-after locations, this immaculately presented four-bedroom semi-detached home on Blakemere Road offers an exceptional opportunity for families seeking a blend of modern living and convenience.

Upon entering, you are immediately struck by the superb standard of finish throughout. The heart of the home is the spacious open-plan kitchen/diner, a contemporary hub ideal for both everyday family life and entertaining, complete with integrated appliances and ample storage space.

Adjacent are two versatile reception rooms, offering flexible space for both relaxation and hosting. Whether arranged as a cosy snug or a more formal lounge, they can be easily adapted to suit a variety of needs.

Practicality is a key feature, with a large utility room providing excellent additional storage and laundry facilities, helping to keep the main living areas clutter-free. The utility room was previously used as a downstairs shower room and could easily be converted back if desired. A separate downstairs cloakroom adds further convenience.

Ascending to the first floor, there are four well-proportioned bedrooms, each offering a comfortable and private retreat. Two benefit from fitted storage, providing excellent solutions for organisation. A modern family bathroom serves the accommodation. The loft has been fully boarded, offering a spacious and practical storage area.

Externally, the property continues to impress. The generous rear garden offers a fantastic space for children, entertaining, or al fresco dining. A particular highlight is the outbuilding, currently used as a home gym, with potential for a home office, studio, or playroom. To the front, a driveway provides off-road parking for two/three vehicles.

This is a fantastic opportunity to acquire a stylish and well-appointed chain-free family home in a prime location, combining comfort, space, and convenience.















# Property Information



## Services:

Mains Water, Mains Electricity, Mains Gas and Mains Drainage

## Tenure:

Freehold

## Local Authority:

Welwyn Hatfield

## Council Tax:

Band F

## EPC:

C

## Directions:

AL8 7PJ

## Viewings:

All viewings strictly by appointment via the vendor's sole agents, Putterills.

**Agents Note:** Whilst every care has been taken to prepare these particulars, they are for guidance purposes only. All measurements are approximate and are for general guidance purposes only and whilst every care has been taken to ensure their accuracy, they should not be relied upon and potential buyers/tenants are advised to recheck the measurements.

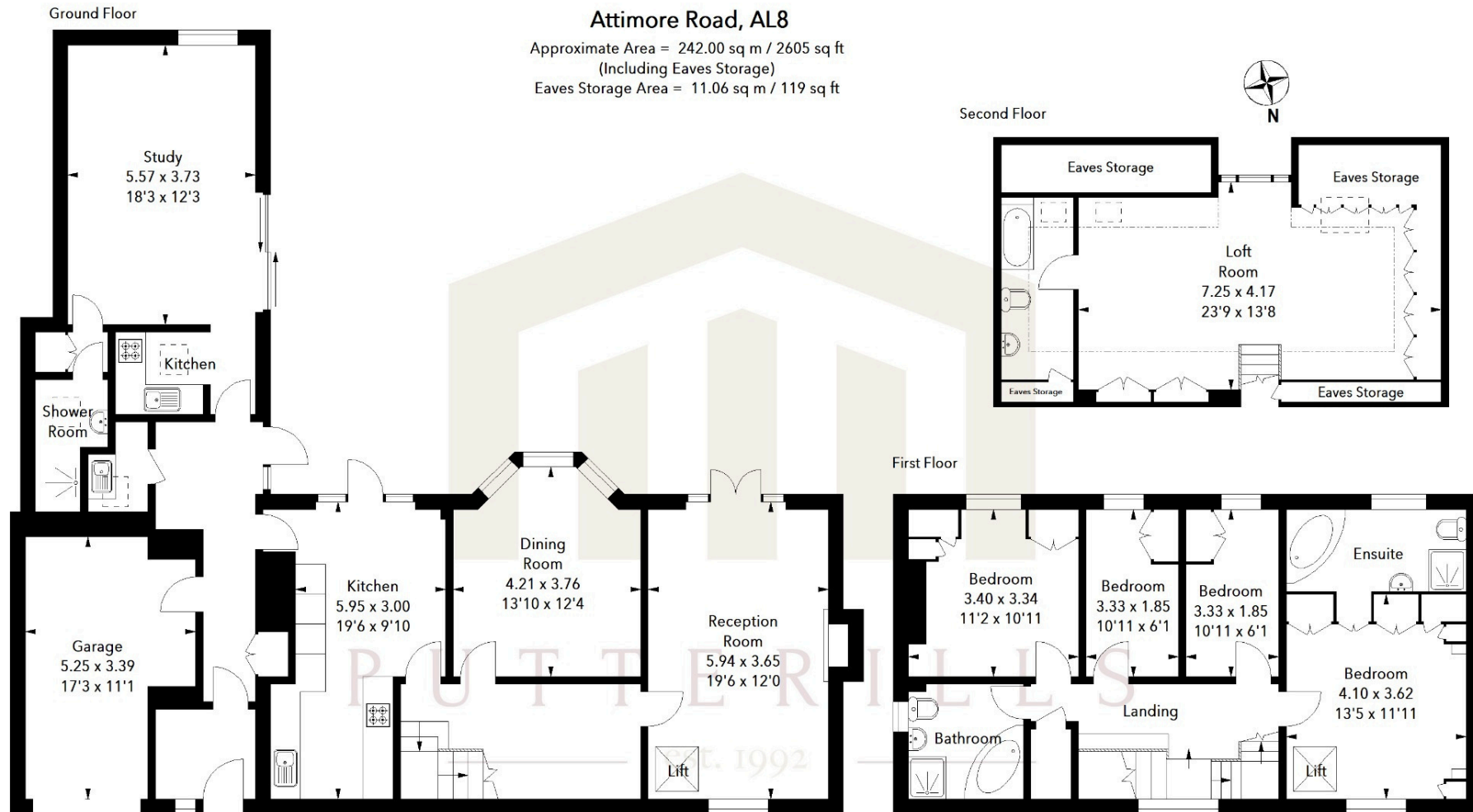

Illustration For Identification Purposes Only.  
 All measurements and areas are approximate, not to scale.  
 © Orange Tree Photography



[putterills.co.uk](http://putterills.co.uk) | 01707 393333 | [wgc@puterills.co.uk](mailto:wgc@puterills.co.uk)  
 34 Wigmores North, Welwyn Garden City, Hertfordshire AL8 6PH