



PUTTERILLS
— est. 1992 —

Farrier Heights, Langley, Hitchin, SG4 7BJ
Guide Price: £625,000

PROPERTY SUMMARY

Set within the sought-after Farrier Heights development, this beautifully presented Peter David Homes property offers a rare combination of countryside tranquillity and everyday convenience. Designed for modern family living, the home centres around an impressive open-plan kitchen and dining space with bifold doors opening onto the garden and far-reaching rural views beyond. A versatile outbuilding provides additional space for home working, fitness or hobbies, while excellent access to Hitchin, Stevenage, the A1(M) and mainline rail services ensures outstanding connectivity. Surrounded by open countryside and benefiting from a strong sense of community, this is a home that perfectly balances lifestyle, practicality and location.

4 

2 

2 











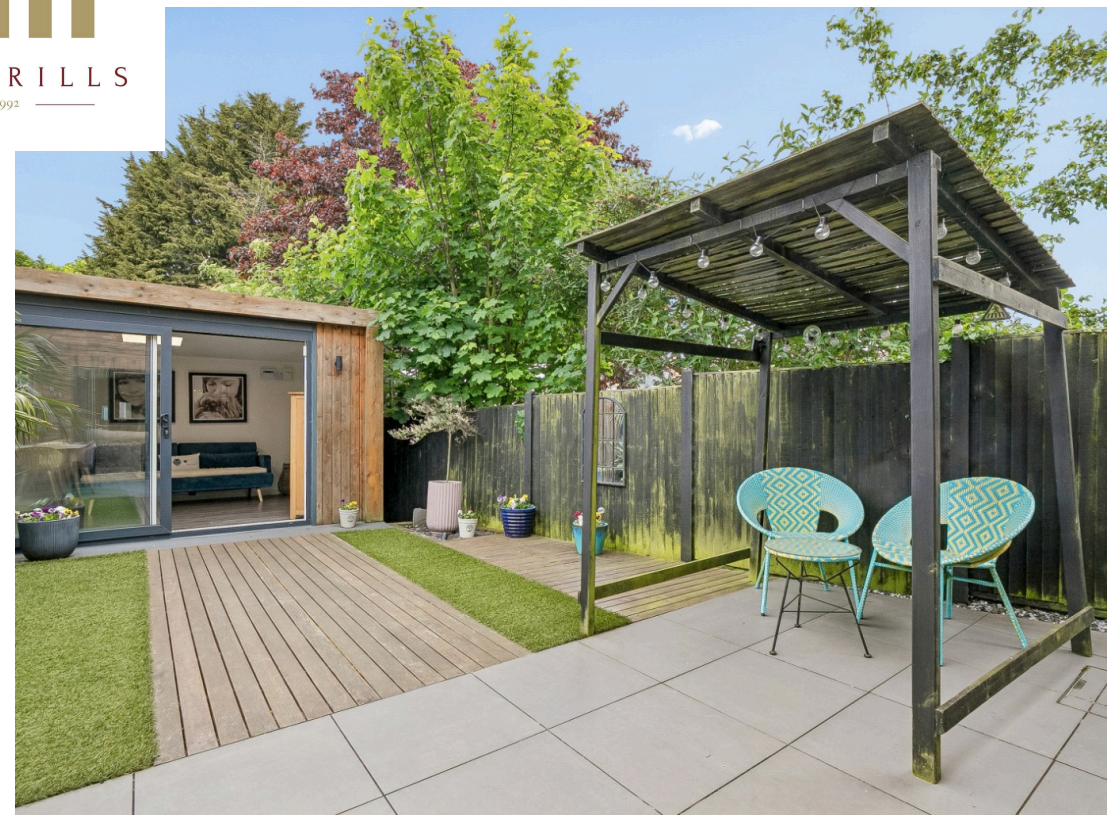





Farrier Heights, SG4

Approximate Area = 150.78 sq m / 1623 sq ft
 (Including Workshop, Studio & Eaves Storage)
 Workshop Area = 9.38 sq m / 101 sq ft
 Studio Area = 11.61 sq m / 125 sq ft
 Eaves Storage Area = 4.55 sq m / 49 sq ft

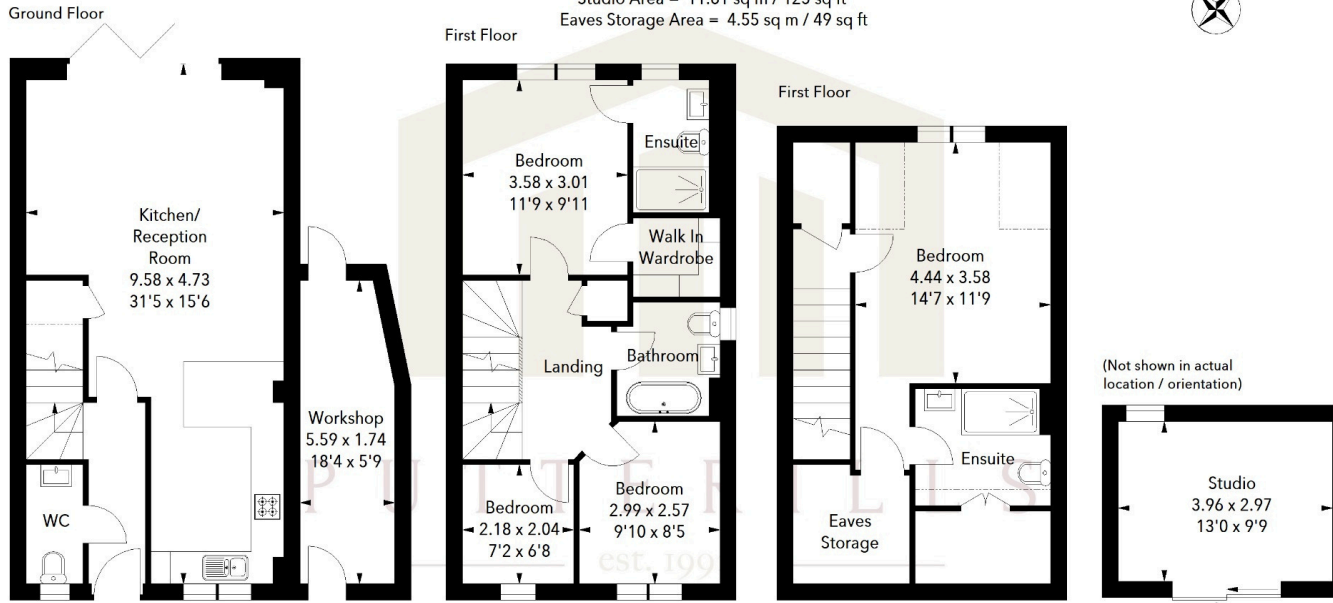

Illustration For Identification Purposes Only.
 All measurements and areas are approximate, not to scale.
 © Orange Tree Photography

LOCAL AUTHORITY
 North Herts

TENURE
 Freehold

COUNCIL TAX BAND
 E

VIEWINGS
 By prior appointment only

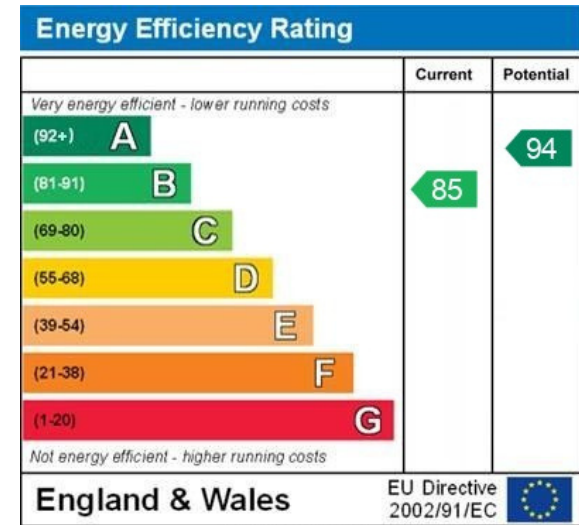

WWW.EPC4U.COM



OFFICE ADDRESS

Putterills Hitchin
 60 Hermitage Road
 Hitchin
 SG5 1DB

CONTACT DETAILS

01462 632222
 hitchin@putterills.co.uk
 www.putterills.co.uk