



PUTTERILLS

— est. 1992 —



Cresswick, Whitwell, Hitchin, SG4 8HU

Guide Price: £950,000

Freehold

PROPERTY SUMMARY

This beautifully presented four-bedroom chalet bungalow in the desirable village of Whitwell offers versatile and well-maintained living, ideal for a range of lifestyles. The property features a bright open-plan kitchen/diner, a dual-aspect living room, a dedicated study, and four well-proportioned bedrooms served by two modern bathrooms, with a ground floor bedroom and bathroom adding future-proof appeal. Set on a generous plot, it boasts a south-facing garden, double garage, and ample driveway parking, all within a charming and well-connected village setting.

4



2



2

















LOCAL AUTHORITY
North Herts

TENURE
Freehold

COUNCIL TAX BAND
F

VIEWINGS
By prior appointment only

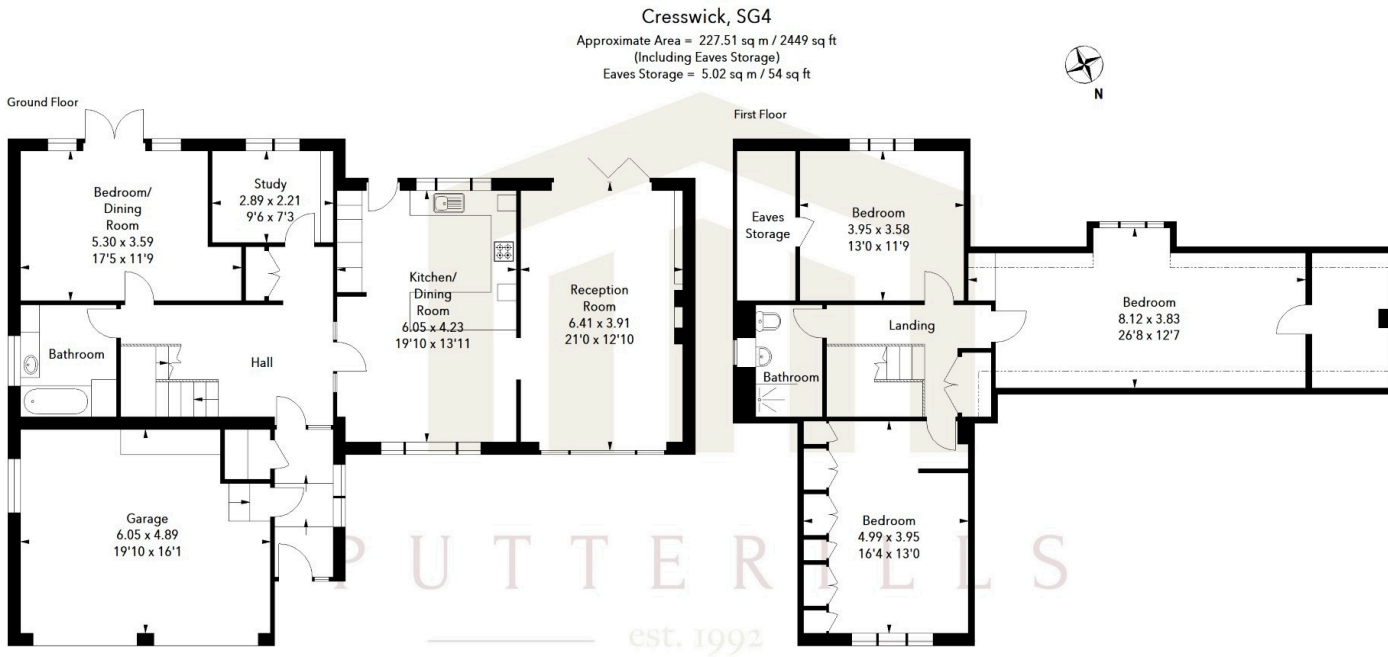

Illustration For Identification Purposes Only.
All measurements and areas are approximate, not to scale.
© Orange Tree Photography



OFFICE ADDRESS

Putterills Hitchin
60 Hermitage Road
Hitchin
SG5 1DB

CONTACT DETAILS

01462 632222
hitchin@putterills.co.uk
www.putterills.co.uk