



PUTTERILLS
— est. 1992 —

The Walled Garden, Tewin Water, Welwyn, AL6 0BZ
Guide Price £875,000

PROPERTY SUMMARY

Set within the exclusive Walled Garden development, this beautifully maintained four-bedroom home offers an exceptional balance of countryside tranquillity and commuter convenience, with Welwyn North station providing direct access to London in approximately 17 minutes. Arranged across three floors and extending to approximately 1,877 sq ft including the garage, the property features bright and versatile living spaces, including a generous open-plan reception and dining room opening onto the garden, a contemporary kitchen, separate study, and four well-proportioned bedrooms, two with en-suite facilities. Surrounded by mature communal parkland and forming part of a warm private community of just 16 homes, this is a rare opportunity to acquire a turnkey home within one of Hertfordshire's most picturesque residential settings.

4 

3 

2 















LOCAL AUTHORITY
Welwyn Hatfield

TENURE Freehold

COUNCIL TAX BAND
G

VIEWINGS

By prior appointment only

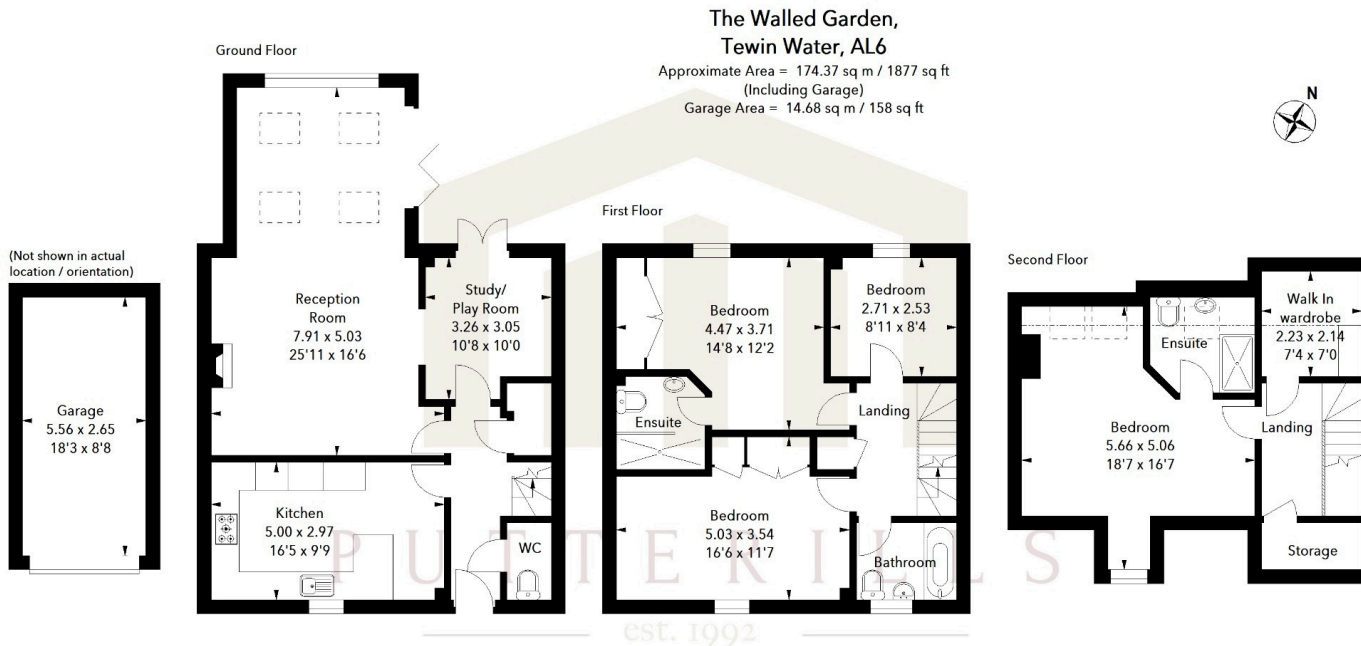
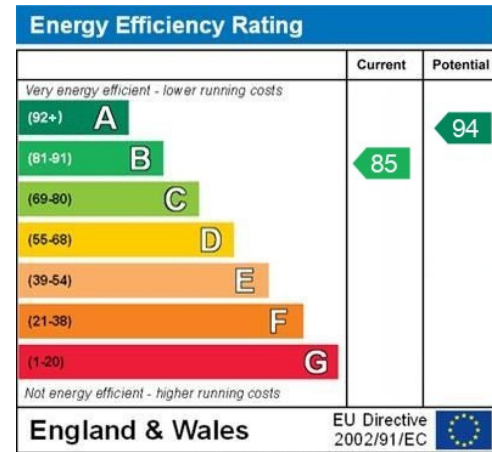

Illustration For Identification Purposes Only.
All measurements and areas are approximate, not to scale.
© Orange Tree Photography



Agents Note: Whilst every care has been taken to prepare these particulars, they are for guidance purposes only. All measurements are approximate and are for general guidance purposes only and whilst every care has been taken to ensure their accuracy, they should not be relied upon and potential buyers/tenants are advised to recheck the measurements



OFFICE ADDRESS
34 Wigmores North
Welwyn Garden
City
Hertfordshire
AL8 6PH

CONTACT DETAILS
[01707 393333](tel:01707393333)
wgc@putterills.co.uk
www.putterills.co.uk