



PUTTERILLS

est. 1992



Cranborne Avenue, Hitchin, SG5 2BS

Guide Price: £1,100,000

Freehold

PROPERTY SUMMARY

This well-maintained four-bedroom detached home in a sought-after area of Hitchin offers spacious and versatile living, set within beautifully landscaped gardens. The ground floor features three flexible reception rooms, a well-appointed kitchen with utility room, and a downstairs bedroom with en-suite, along with lift access from the garage for added convenience. Upstairs are three well-proportioned bedrooms and a modern family bathroom, with potential for additional en-suites. Further benefits include a generous garage, ample off-street parking, and a versatile outbuilding with electricity and water.

4



2



2



















PUTTERILLS
— est. 1992 —



LOCAL AUTHORITY
North Herts

TENURE
Freehold

COUNCIL TAX BAND
F

VIEWINGS
By prior appointment only

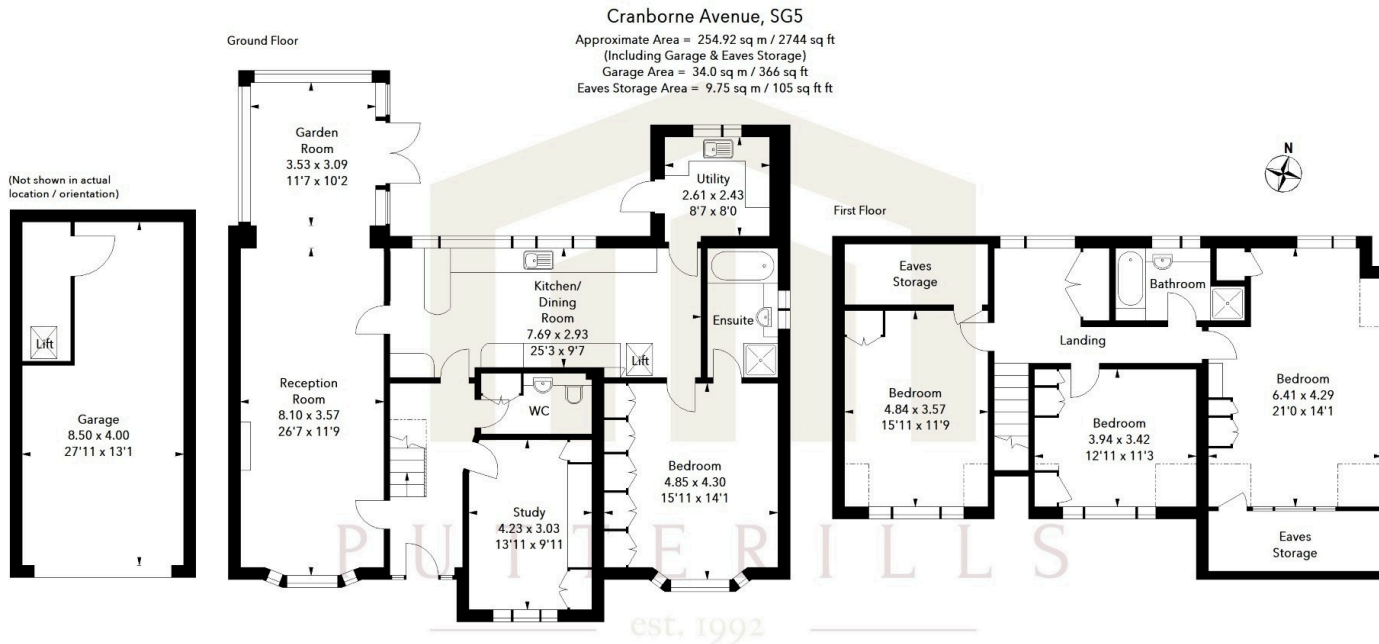

Illustration For Identification Purposes Only.
All measurements and areas are approximate, not to scale.
© Orange Tree Photography



OFFICE ADDRESS

Putterills Hitchin
60 Hermitage Road
Hitchin
SG5 1DB

CONTACT DETAILS

01462 632222
hitchin@putterills.co.uk
www.putterills.co.uk