



PUTTERILLS

est. 1992



Claves Crescent, Welwyn Garden City, AL7 1WN
Offers Over £500,000

PROPERTY SUMMARY

Nestled in the highly sought-after locale of Welwyn Garden City, this exquisite three-bedroom end-of-terrace house presents a superb opportunity for discerning buyers seeking a modern and comfortable family home. Constructed in 2022, this property boasts a contemporary design and a host of desirable features, ensuring a seamless transition for its new owners and has the added benefit of approx. 7 years remaining on it's 10 year new build guarantee.

This property, with its three bedrooms, two bathrooms, off-road parking, and private garden, represents an exceptional opportunity to acquire a modern home in a desirable location. Built in 2022, it offers the peace of mind that comes with a newer build, including energy efficiency and contemporary design.

3



2



1











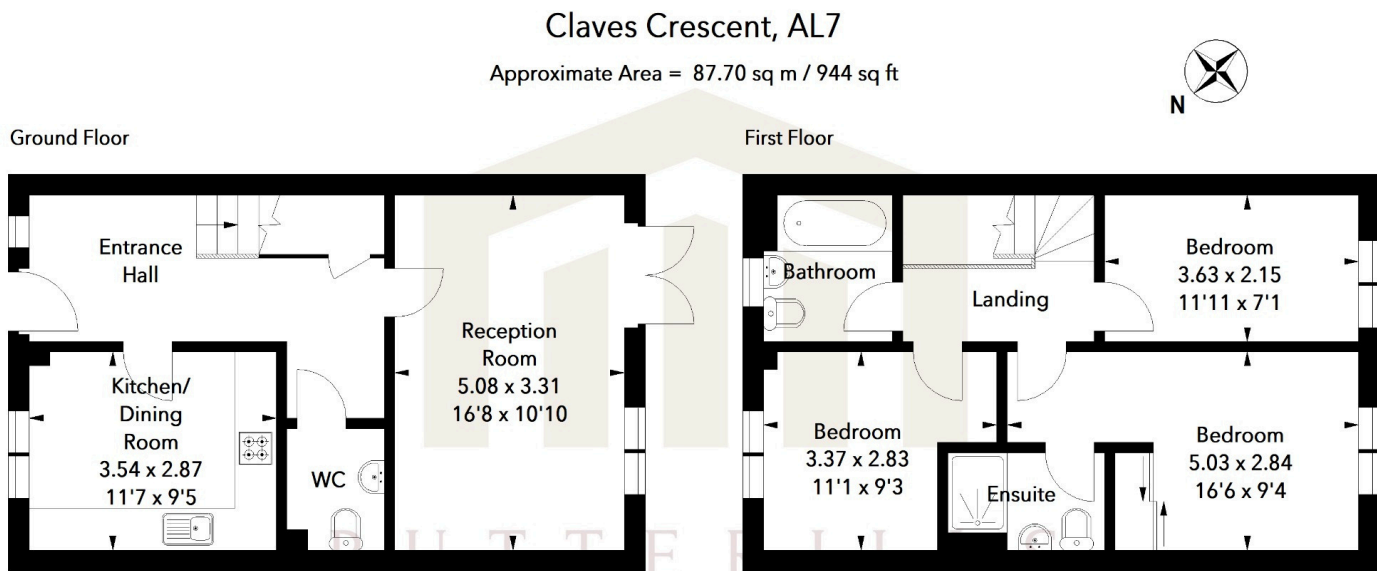

Illustration For Identification Purposes Only.
All measurements and areas are approximate, not to scale.
© Orange Tree Photography

LOCAL AUTHORITY
Welwyn Hatfield

TENURE Freehold

COUNCIL TAX BAND
D

VIEWINGS
By prior appointment only

Score	Energy rating	Current	Potential
92+	A		96 A
81-91	B	84 B	
69-80	C		
55-68	D		
39-54	E		
21-38	F		
1-20	G		

Agents Note: Whilst every care has been taken to prepare these particulars, they are for guidance purposes only. All measurements are approximate and are for general guidance purposes only and whilst every care has been taken to ensure their accuracy, they should not be relied upon and potential buyers/tenants are advised to recheck the measurements



OFFICE ADDRESS
34 Wigmores North
Welwyn Garden
City
Hertfordshire
AL8 6PH

CONTACT DETAILS
[01707 393333](tel:01707393333)
lwgc@putterills.co.uk
www.putterills.co.uk