



P U T T E R I L L S

— est. 1992 —

Dalewood, Welwyn Garden City, AL7 2JP  
Guide Price £450,000



# PROPERTY SUMMARY

Nestled within the highly sought-after Dalewood area of Welwyn Garden City, this immaculately presented three-bedroom house offers an exceptional opportunity for families and professionals alike. Boasting a guide price of £450,000, this property has been thoughtfully modernised throughout, presenting a contemporary and inviting living space ready for immediate enjoyment.

3 

1 

1 

With its blend of contemporary interiors, practical features, and desirable outdoor space, coupled with its proximity to essential amenities and schooling, early viewing is highly recommended to fully appreciate all that this exceptional property has to offer.





















Approximate Gross Internal Area  
 Ground Floor = 48.5 sq m / 522 sq ft  
 First Floor = 44.9 sq m / 483 sq ft  
 Total = 93.4 sq m / 1,005 sq ft

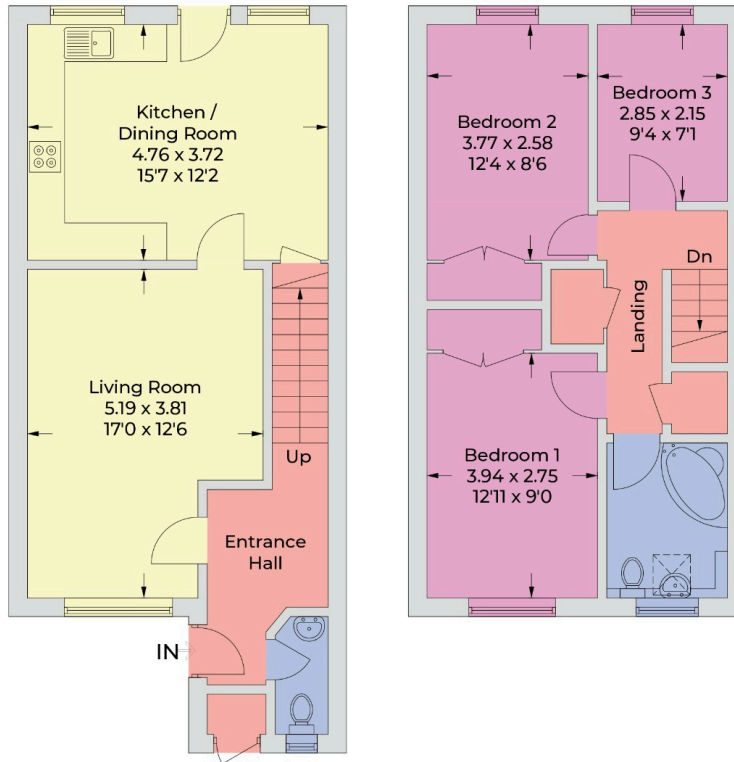

Ground Floor

First Floor

Illustration for identification purposes only,  
 measurements are approximate, not to scale.  
 © CJ Property Marketing Produced for Putterills

LOCAL AUTHORITY  
 Welwyn Hatfield

TENURE Freehold

COUNCIL TAX BAND  
 D

VIEWINGS  
 By prior appointment only

Score	Energy rating	Current	Potential
92+	A		
81-91	B		89 B
69-80	C	70 C	
55-68	D		
39-54	E		
21-38	F		
1-20	G		

Agents Note: Whilst every care has been taken to prepare these particulars, they are for guidance purposes only. All measurements are approximate and are for general guidance purposes only and whilst every care has been taken to ensure their accuracy, they should not be relied upon and potential buyers/tenants are advised to recheck the measurements



OFFICE ADDRESS  
 34 Wigmores North  
 Welwyn Garden  
 City  
 Hertfordshire  
 AL8 6PH

CONTACT DETAILS  
 01707 393333  
 lwgc@putterills.co.uk  
 www.putterills.co.uk