



P U T T E R I L L S

— est. 1992 —



Guessens Road, Welwyn Garden City, AL8 6RE

Guide Price: £500,000

EPC: D

PROPERTY SUMMARY

Nestled on the highly sought-after Guessens Road, this charming three-bedroom house presents an exceptional opportunity for families and professionals seeking a well-located and versatile home in Welwyn Garden City.

Offered chain free and with a guide price of £500,000, this property combines comfortable living spaces with the convenience of being incredibly close to both the town centre and the mainline train station, making it ideal for commuters and those who appreciate easy access to local amenities.

3



1



2

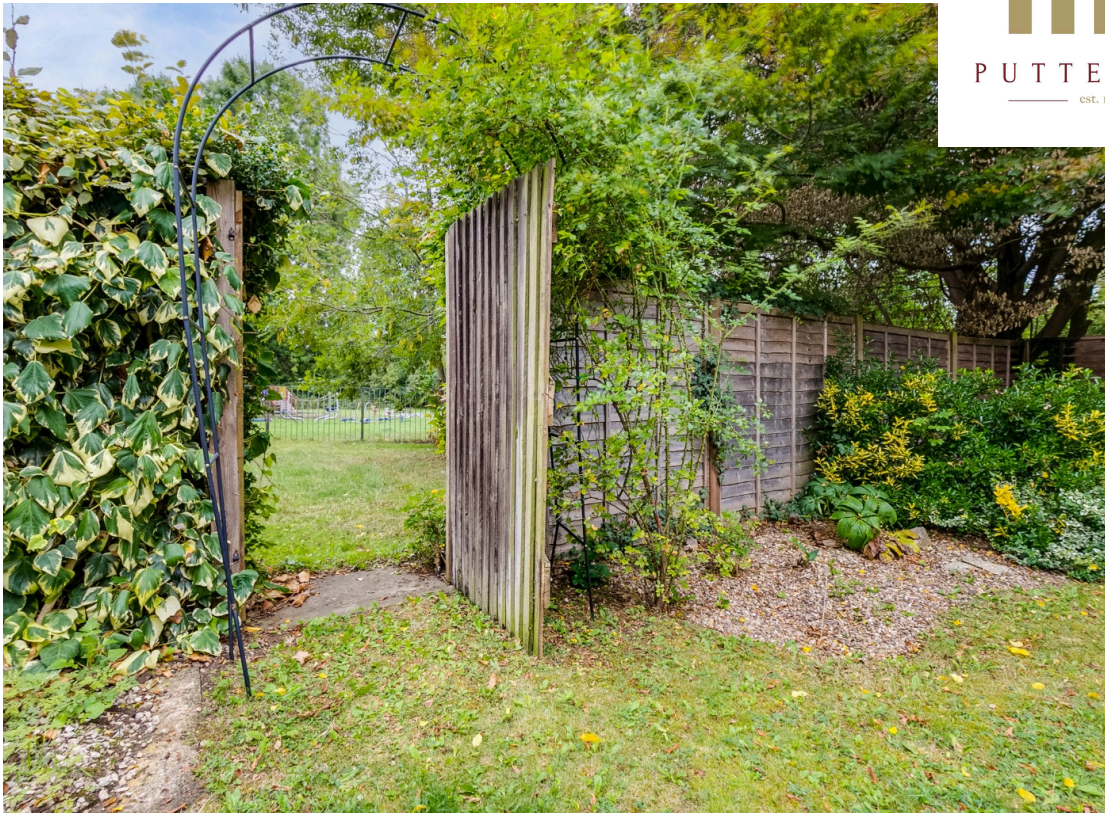













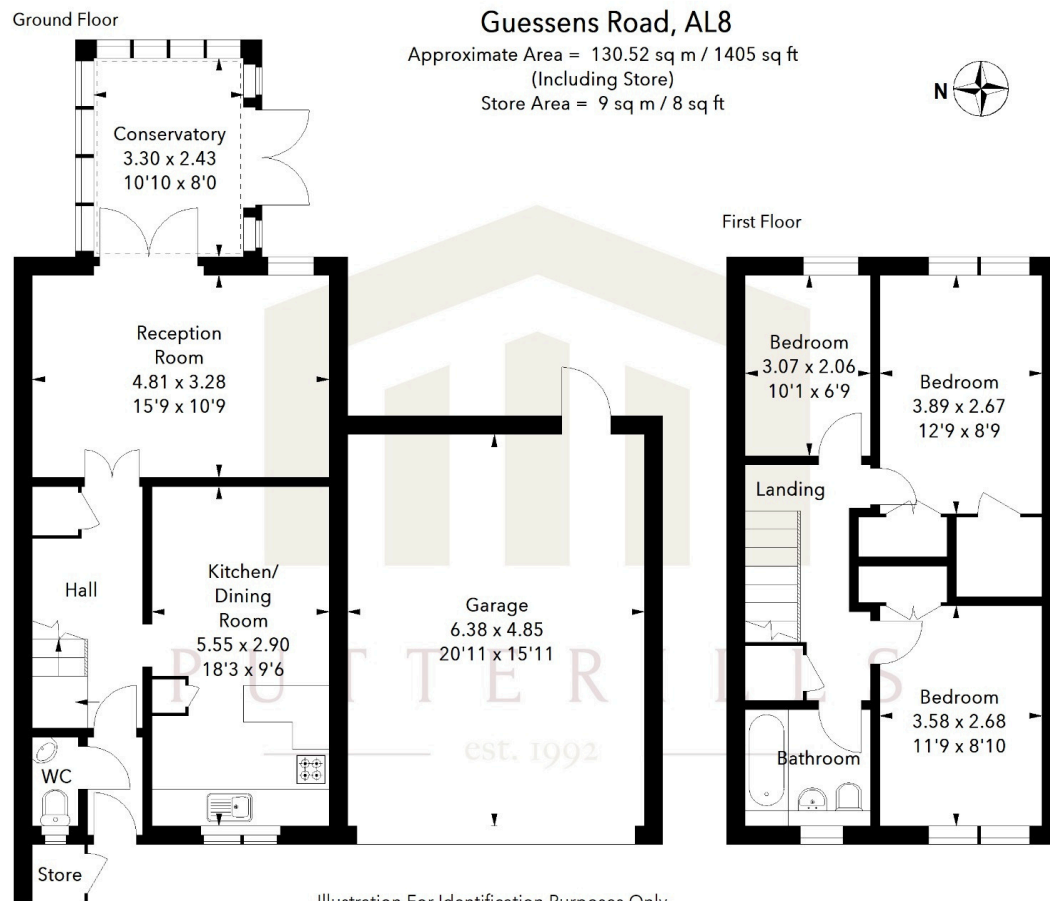

Illustration For Identification Purposes Only.
All measurements and areas are approximate, not to scale.
© Orange Tree Photography

LOCAL AUTHORITY
Welwyn Hatfield

TENURE
Freehold

COUNCIL TAX BAND
D

VIEWINGS
By prior appointment only

Score	Energy rating	Current	Potential
92+	A		
81-91	B		86 B
69-80	C	70 C	
55-68	D		
39-54	E		
21-38	F		
1-20	G		

Agents Note: Whilst every care has been taken to prepare these particulars, they are for guidance purposes only. All measurements are approximate and are for general guidance purposes only and whilst every care has been taken to ensure their accuracy, they should not be relied upon and potential buyers/tenants are advised to recheck the measurements



OFFICE ADDRESS

34 Wigmores North
Welwyn Garden
City Hertfordshire
AL8 6PH

CONTACT DETAILS

01707 393333
wgc@putterills.co.uk
www.putterills.co.uk