



Knightsfield, Welwyn Garden City, AL8 7JE

Guide Price: £450,000

EPC: E

PROPERTY SUMMARY

Set within the sought-after West Side of Welwyn Garden City, this thoughtfully modernised end-terrace home offers stylish, light-filled interiors, a sleek reconfigured kitchen, and a sunny, landscaped garden with extension potential.

Designed for contemporary family living and entertaining, the versatile ground floor includes a bright conservatory and spacious reception areas, while upstairs features three well-appointed bedrooms and a modernised family bathroom.

This immaculate, turn-key property is further enhanced by gas central heating, electric underfloor heating in the reception spaces, and a full re-wire with a new consumer unit completed in 2019.

3



1



2







PUTTERILLS
— est. 1992 —











Approximate Gross Internal Area
 Ground Floor = 48.7 sq m / 524 sq ft
 First Floor = 36.0 sq m / 387 sq ft
 Total = 84.7 sq m / 911 sq ft



LOCAL AUTHORITY
 Welwyn Hatfield

TENURE
 Freehold

COUNCIL TAX BAND
 C

VIEWINGS
 By prior appointment only

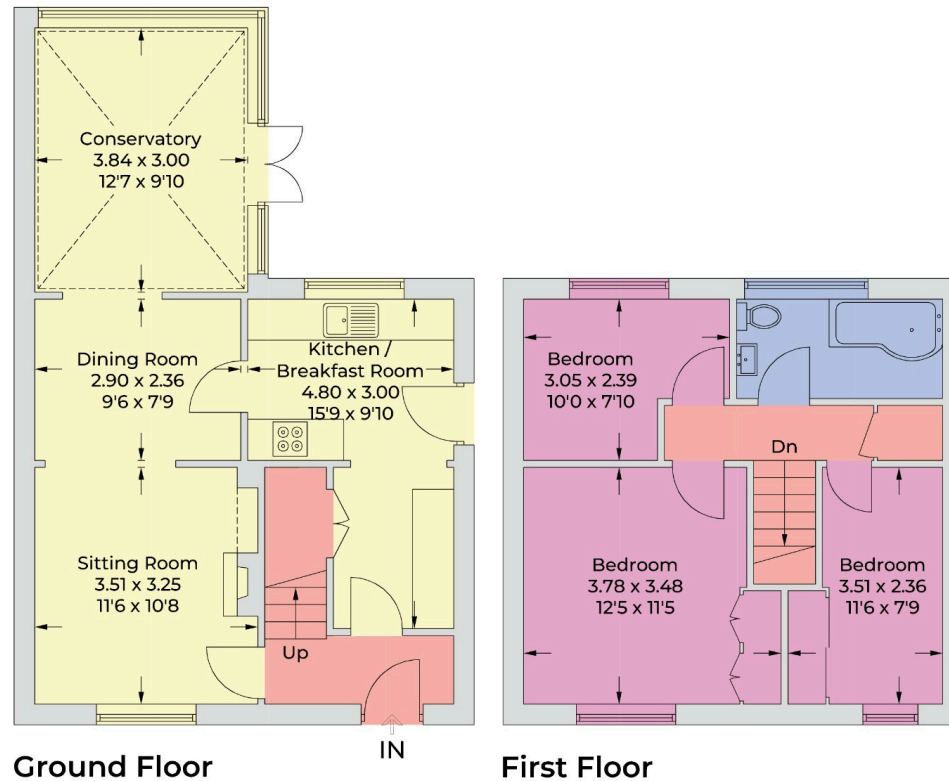

Illustration for identification purposes only,
 measurements are approximate, not to scale.

Score	Energy rating	Current	Potential
92+	A		
81-91	B		87 B
69-80	C		
55-68	D		
39-54	E	54 E	
21-38	F		
1-20	G		

Agents Note: Whilst every care has been taken to prepare these particulars, they are for guidance purposes only. All measurements are approximate and are for general guidance purposes only and whilst every care has been taken to ensure their accuracy, they should not be relied upon and potential buyers/tenants are advised to recheck the measurements



OFFICE ADDRESS

34 Wigmores North
 Welwyn Garden
 City Hertfordshire
 AL8 6PH

CONTACT DETAILS

01707 393333
wgc@putterills.co.uk
www.putterills.co.uk