



PUTTERILLS

— est. 1992 —



£850,000

Guessens Road

Welwyn Garden City AL8 6QW

PROPERTY SUMMARY

A Rare Piece of Garden City Heritage – Guessens Road, Welwyn Garden City

Once home to Sir Ebenezer Howard OBE, founder of the Garden City movement, this beautifully extended three-bedroom residence offers a rare opportunity to own a part of local history. Positioned on the highly sought-after Guessens Road, the property blends character and heritage with modern comfort and convenience.

Internally, the home offers a spacious and light-filled layout, with two versatile reception rooms ideal for both entertaining and family life. A thoughtfully extended footprint includes a stylish, contemporary kitchen and a practical ground floor shower room. Upstairs, three generous bedrooms are complemented by a modern family bathroom and an en-suite to the principal room.

Outside, a landscaped rear garden provides a tranquil setting for relaxing or entertaining, while a private driveway and garage offer secure off-street parking – a true asset in this central location.

Perfectly placed within walking distance of the town centre and train station, this chain-free home combines historical significance with an unbeatable location for commuting, lifestyle, and convenience.

3



2



2













SIR EBENEZER HOWARD O.B.E.
CREATOR OF GARDEN CITIES
LIVED HERE 1923 - 1928











JOHN
LEWIS
& PARTNERS

LOCAL AUTHORITY
Welwyn & Hatfield

TENURE

COUNCIL TAX BAND
F

VIEWINGS

By prior appointment only

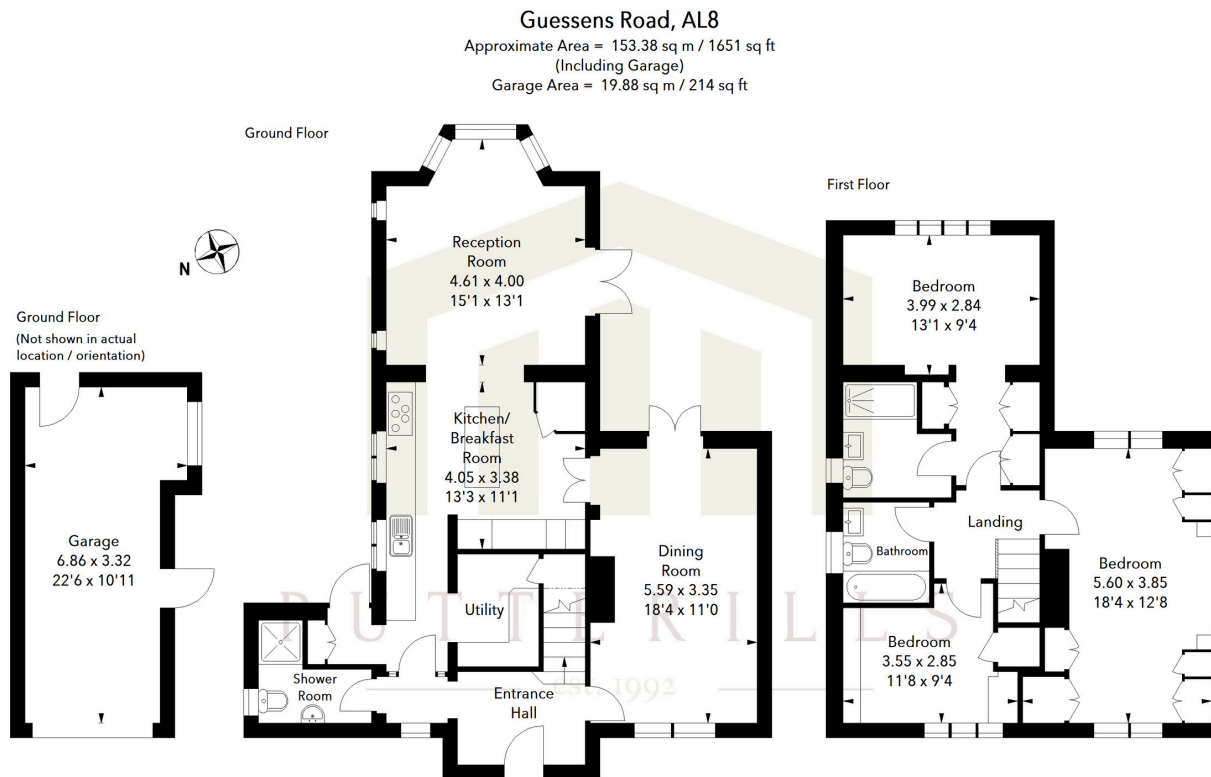

Illustration For Identification Purposes Only.
All measurements and areas are approximate, not to scale.
© Orange Tree Photography

Score	Energy rating	Current	Potential
92+	A		
81-91	B		
69-80	C		74 C
55-68	D	68 D	
39-54	E		
21-38	F		
1-20	G		

Agents Note: Whilst every care has been taken to prepare these particulars, they are for guidance purposes only. All measurements are approximate and are for general guidance purposes only and whilst every care has been taken to ensure their accuracy, they should not be relied upon and potential buyers/tenants are advised to recheck the measurements



OFFICE ADDRESS

34 Wigmores N,
Welwyn Garden
City AL8 6PH

CONTACT DETAILS

01707 393333
wgc@putterills.co.uk
www.putterills.co.uk