



**Laxton Gardens, Baldock, SG7 6DA**  
**Guide Price: £525,000**  
**Freehold**



# PROPERTY SUMMARY

Situated in the sought-after Laxton Gardens, Baldock, this extended family home offers spacious and flexible living with three to four bedrooms, two reception rooms, and a bright open-plan kitchen/dining area. A utility room, en-suite to the principal bedroom, and a well-appointed family bathroom add further practicality. Outside, the property features a private driveway and a generous garden with a large shed for storage or flexible use. Ideally located near Baldock town centre, top schools, and direct rail links to London, this home is perfect for families and commuters seeking space, comfort, and convenience.

4



2



2



















PUTTERILLS  
— est. 1992 —

























Laxton Gardens, SG7  
 Approximate Area = 133.69 sq m / 1439 sq ft  
 (Including Shed)  
 Shed Area = 16.35 sq m / 176 sq ft

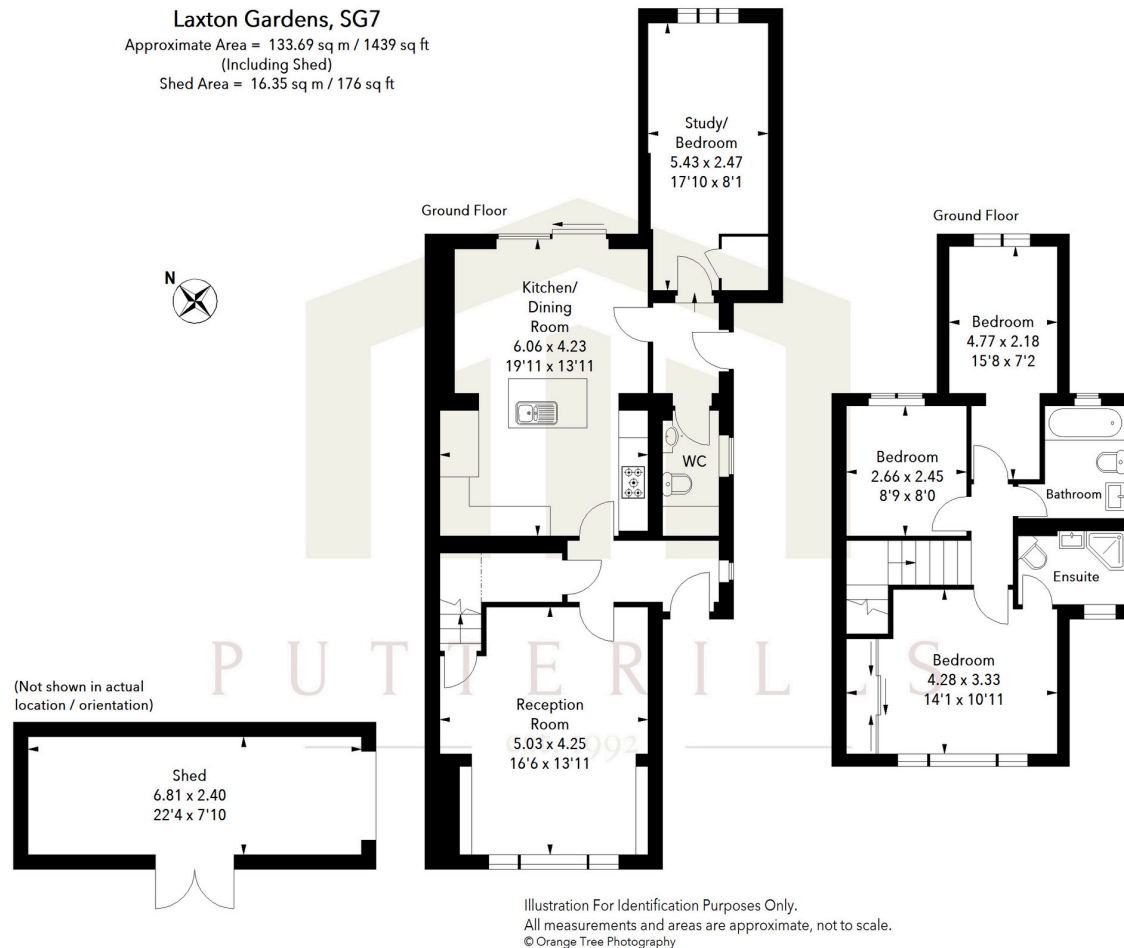

LOCAL AUTHORITY  
 North Herts

TENURE  
 Freehold

COUNCIL TAX BAND  
 D

VIEWINGS  
 By prior appointment only

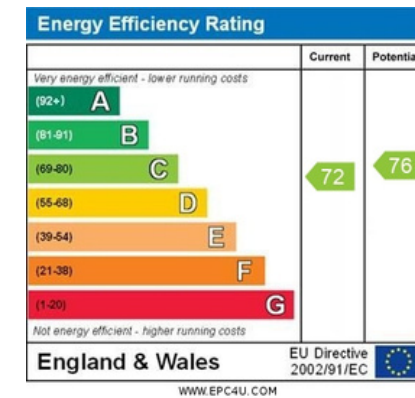

Agents Note: Whilst every care has been taken to prepare these particulars, they are for guidance purposes only. All measurements are approximate and are for general guidance purposes only and whilst every care has been taken to ensure their accuracy, they should not be relied upon and potential buyers/tenants are advised to recheck the measurements



#### OFFICE ADDRESS

Putterills Hitchin  
 60 Hermitage Road  
 Hitchin  
 SG5 1DB

#### CONTACT DETAILS

01462 632222  
 hitchin@putterills.co.uk  
 www.putterills.co.uk