



**Traherne Close, Hitchin, SG4 9DS**  
**Guide Price £535,000**  
**Freehold**  
**EPC: D**



# PROPERTY SUMMARY

This beautifully presented two-bedroom semi-detached bungalow is located in a quiet cul-de-sac in Hitchin. It features a modern open-plan kitchen and dining area, a spacious living room, and a stylish shower room. Both bedrooms offer comfort and tranquility. Outside, the property boasts attractive gardens, a garage, and ample parking. Just a short walk from Hitchin town centre, it offers both peace and convenience.

2	
1	
1	























PUTTERILLS  
— est. 1992 —













LOCAL AUTHORITY  
North Herts

TENURE  
Freehold

COUNCIL TAX BAND  
D

VIEWINGS

By prior appointment only

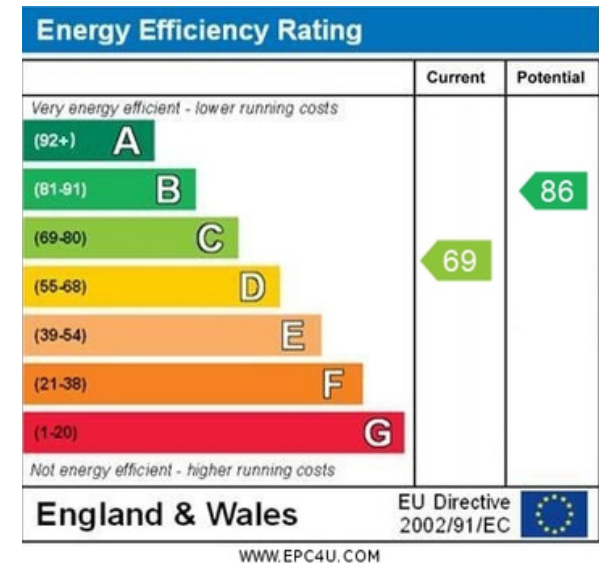
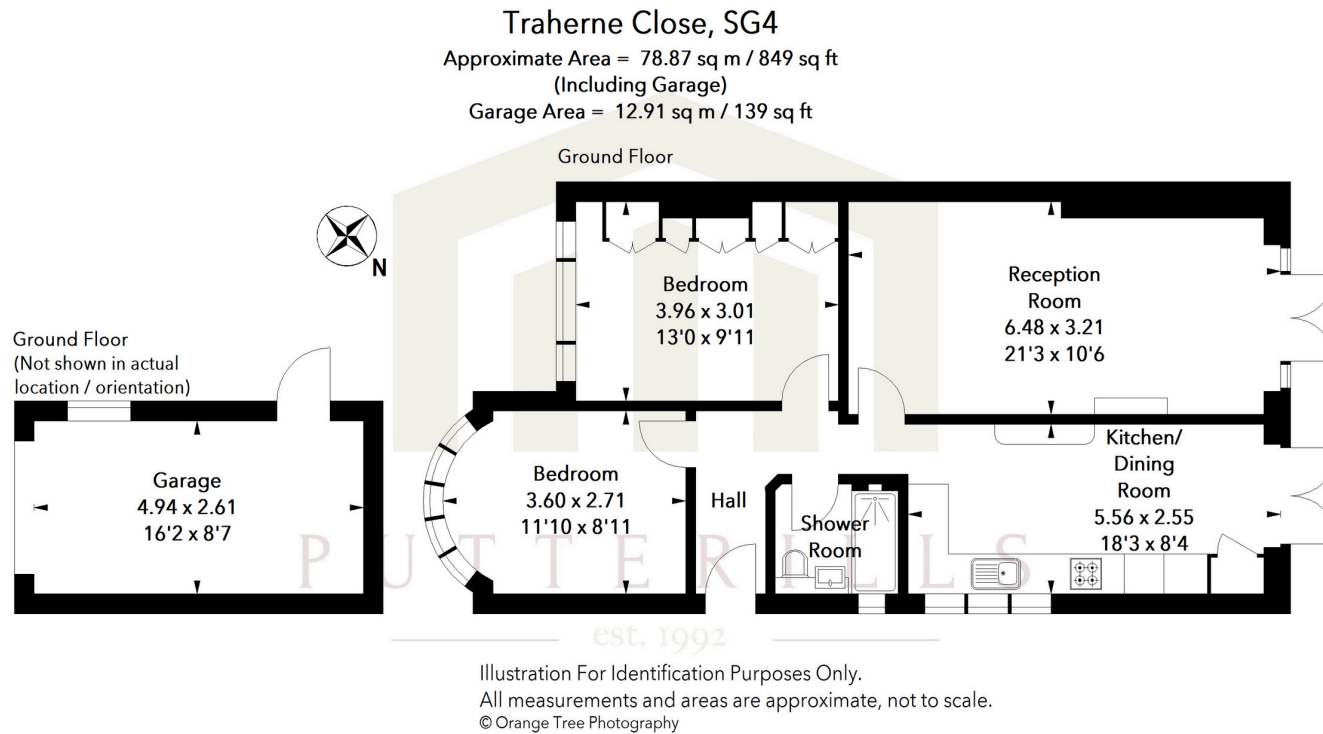

Agents Note: Whilst every care has been taken to prepare these particulars, they are for guidance purposes only. All measurements are approximate and are for general guidance purposes only and whilst every care has been taken to ensure their accuracy, they should not be relied upon and potential buyers/tenants are advised to recheck the measurements



OFFICE ADDRESS

Putterills Hitchin  
60 Hermitage Road  
Hitchin  
SG5 1DB

CONTACT DETAILS

01462 632222  
hitchin@putterills.co.uk  
www.putterills.co.uk