



**Home Farm Court, Putteridge Park**

**Guide Price: £900,000**

**Freehold**

**EPC: C**



# PROPERTY SUMMARY

This 17th-century barn conversion in Putteridge Park offers a unique blend of historical charm and modern living. Spanning 1,805 sq. ft. over two floors, the spacious home features a well-designed kitchen, utility room, cloakroom, and four double bedrooms, including a master with an en suite shower room.

Set on 0.75 acres, the property boasts beautiful woodland once part of Putteridge Bury's formal gardens. With off-street parking for two cars and situated in a quiet, communal courtyard of 15 homes, this property offers privacy and a strong sense of community. The location, near Putteridge Bury Park, offers tranquil surroundings with access to nearby amenities and excellent schools.

4



2



2

































LOCAL AUTHORITY  
North Hertfordshire

TENURE  
Freehold

COUNCIL TAX BAND: G

VIEWINGS  
By prior appointment only

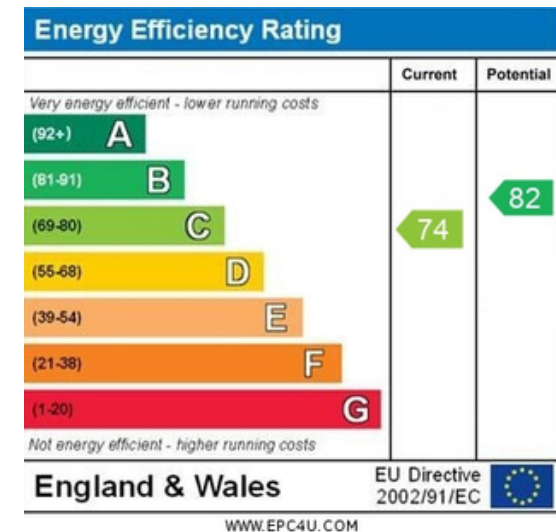
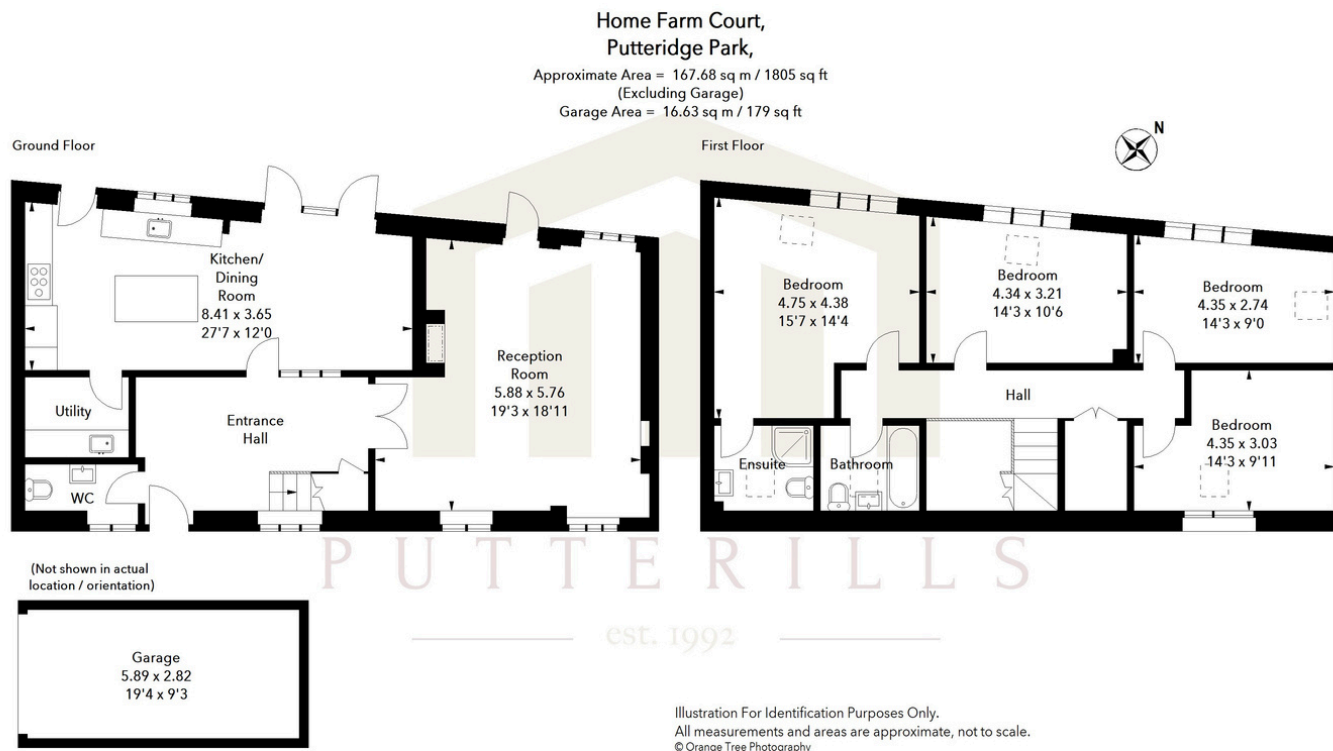

Agents Note: Whilst every care has been taken to prepare these particulars, they are for guidance purposes only. All measurements are approximate and are for general guidance purposes only and whilst every care has been taken to ensure their accuracy, they should not be relied upon and potential buyers/tenants are advised to recheck the measurements



OFFICE ADDRESS  
Putterills Hitchin  
60 Hermitage Road  
Hitchin  
SG5 1DB

CONTACT DETAILS

01462 632222  
hitchin@putterills.co.uk  
www.putterills.co.uk