



  
**PUTTERILLS**  
— est. 1992 —

*R*  
**Guide Price £415,000**

**Waterlow Mews, Little Wymondley, Hitchin, Hertfordshire, SG4 7HL**

**Freehold**

**EPC: D**

# PROPERTY SUMMARY

This contemporary 3-bedroom house in Waterlow Mews, Little Wymondley, is a comfortable home designed for modern living. The ground floor features a sleek kitchen and well proportioned living room, ideal for entertaining or family time. Upstairs, the spacious master bedroom and two additional well-sized rooms offer versatility for families or home office needs.

The property includes two high-quality bathrooms, one being an en-suite to the master bedroom and a low-maintenance garden, perfect for outdoor relaxation. With off-street parking, a garage, and excellent transport links via the A1(M), convenience is assured. Located in a tranquil yet well-connected area near Hitchin, it offers easy access to amenities, schools, and leisure options.

3



2



1











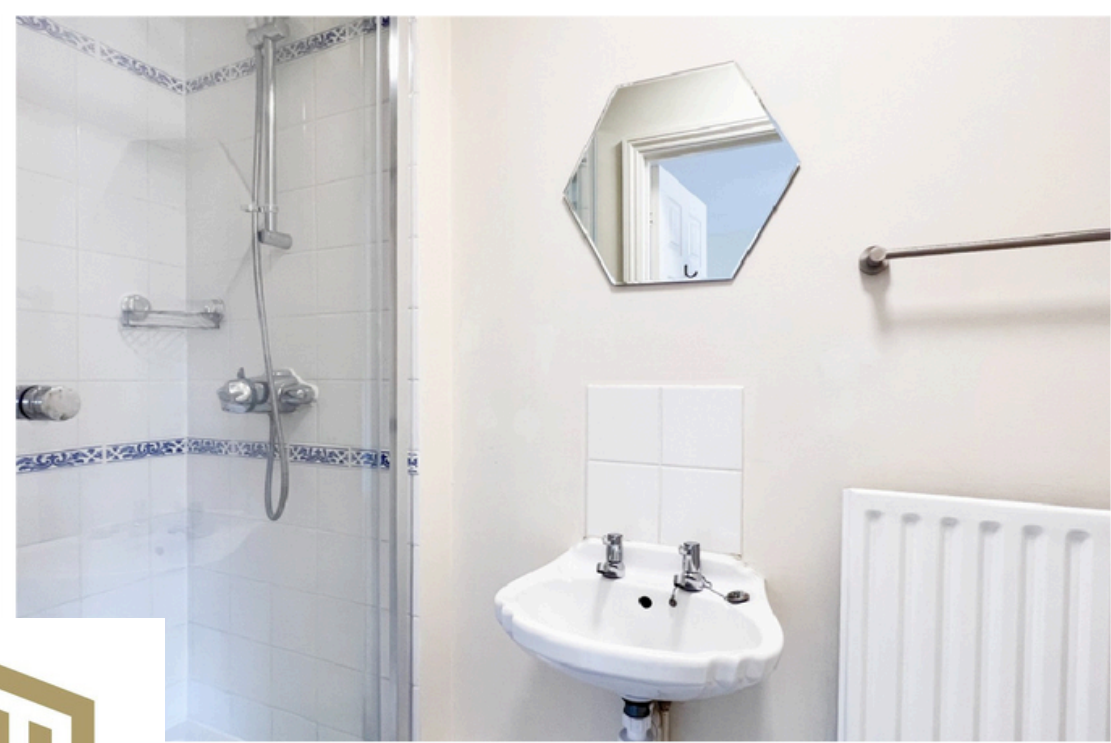

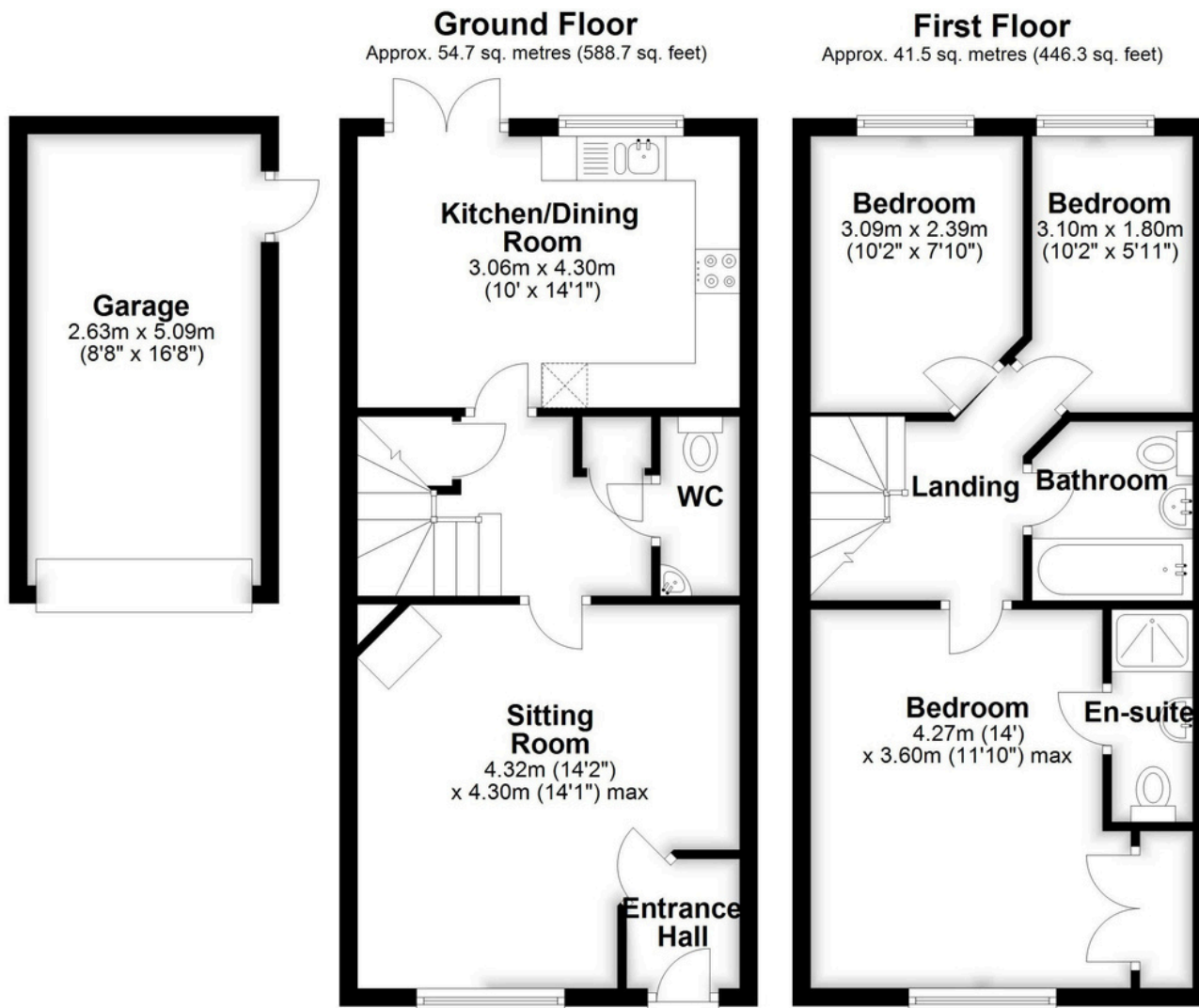

Total area: approx. 96.2 sq. metres (1035.0 sq. feet)

LOCAL AUTHORITY  
North Herts  
TENURE  
Freehold

COUNCIL TAX BAND  
D

VIEWINGS  
By prior appointment only

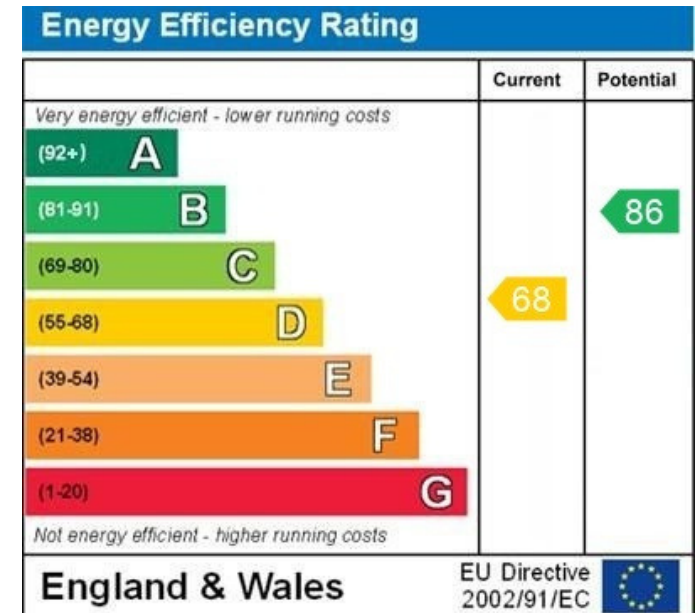

WWW.EPC4U.COM

Agents Note: Whilst every care has been taken to prepare these particulars, they are for guidance purposes only. All measurements are approximate and are for general guidance purposes only and whilst every care has been taken to ensure their accuracy, they should not be relied upon and potential buyers/tenants are advised to recheck the measurements



OFFICE ADDRESS  
Putterills Hitchin  
60 Hermitage Road  
Hitchin  
SG5 1DB

CONTACT DETAILS

01462 632222  
hitchin@putterills.co.uk  
www.putterills.co.uk