



PUTTERILLS

est. 1992

**Walton Close, Shefford SG17 5RX**  
**Guide Price £525,000**  
**Freehold**

# PROPERTY SUMMARY

This 4-bedroom house in Walton Close, Shefford, offers a spacious and versatile living experience. Key features include an open-plan kitchen/diner, a home office/study, and a converted garage that can serve various purposes. The block-paved driveway provides parking for three cars.

It is situated in a desirable school catchment area, including Robert Bloomfield and Samuel Whitbread Academy, and features a private rear garden for relaxation. Convenient transport links to major roads and public transportation enhance its appeal, while Shefford offers various community amenities. This property is ideal for families and commuters alike.

4



2



3









ADVICE FROM THE  
**OCEAN**  
BE SHORE OF YOURSELF  
*make waves*  
AVOID PIER PRESSURE  
DON'T GET TIDE DOWN  
*sea life's beauty*  
COME OUT OF YOUR SHELL  
TAKE TIME TO COAST













# Walton Close, SG17

Approximate Area = 141.58 sq m / 1524 sq ft



Ground Floor

First Floor

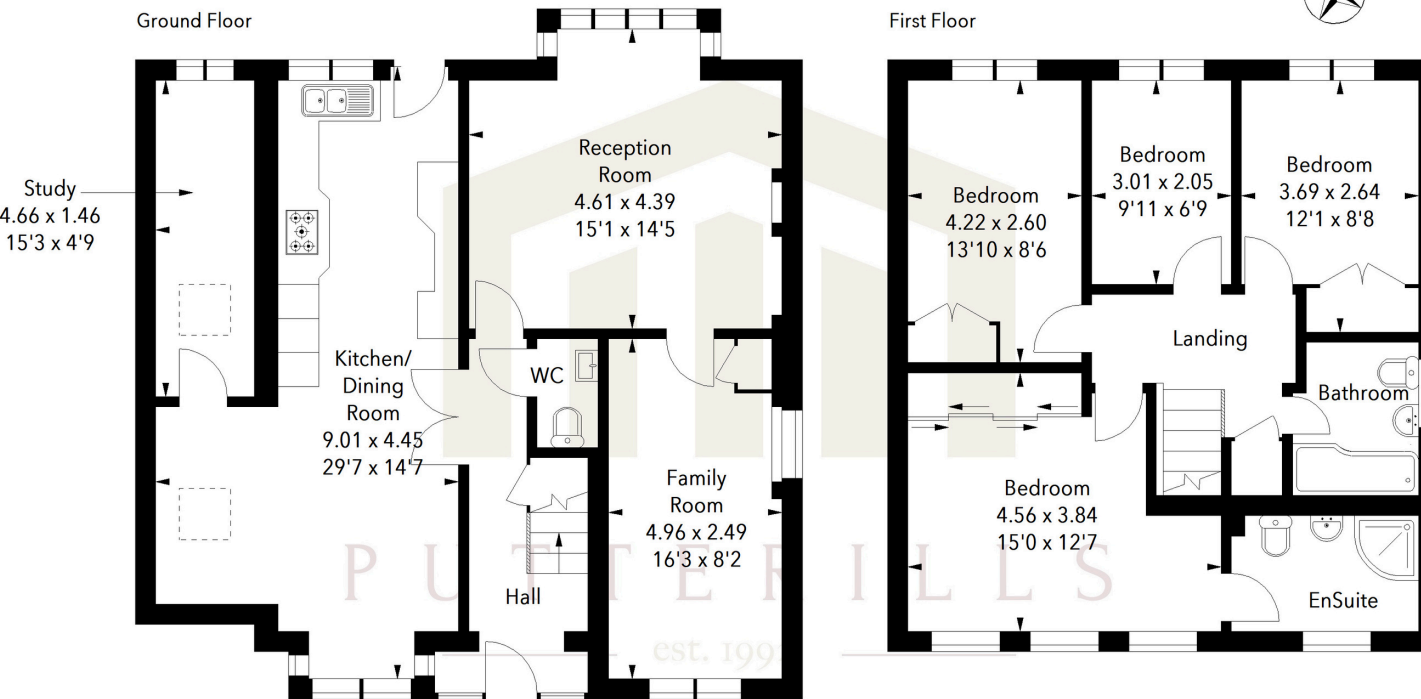

Illustration For Identification Purposes Only.  
All measurements and areas are approximate, not to scale.  
© Orange Tree Photography

LOCAL AUTHORITY  
Central Bedfordshire

TENURE  
Freehold

COUNCIL TAX BAND  
E

VIEWINGS  
By prior appointment only

Energy Efficiency Rating		
	Current	Potential
Very energy efficient - lower running costs		
(92+) <b>A</b>		
(81-91) <b>B</b>		
(69-80) <b>C</b>		
(55-68) <b>D</b>		
(39-54) <b>E</b>		
(21-38) <b>F</b>		
(1-20) <b>G</b>		
Not energy efficient - higher running costs		
	74	82
<b>England &amp; Wales</b>		EU Directive 2002/91/EC

WWW.EPC4U.COM

Agents Note: Whilst every care has been taken to prepare these particulars, they are for guidance purposes only. All measurements are approximate and are for general guidance purposes only and whilst every care has been taken to ensure their accuracy, they should not be relied upon and potential buyers/tenants are advised to recheck the measurements.



### OFFICE ADDRESS

Putterills Hitchin  
60 Hermitage Road  
Hitchin  
SG5 1DB

### CONTACT DETAILS

01462 632222  
hitchin@putterills.co.uk  
www.putterills.co.uk