



PUTTERILLS

est. 1992

**Village Street, Langley**  
**Guide Price: £625,000**  
**Freehold**



# PROPERTY SUMMARY

This charming 3-bedroom bungalow is located in the peaceful Langley Village, Hitchin, offering scenic countryside views. It features a spacious open-plan kitchen/diner, a cosy lounge with panoramic vistas, and three large bedrooms. The property has potential for extension (subject to planning consent) and includes a lush garden ideal for outdoor entertaining, along with a spacious driveway for multiple vehicles. Conveniently located near Codicote High Street and Hitchin Train Station, this bungalow offers a perfect blend of tranquillity and accessibility. Ideal for families or those seeking a serene village lifestyle.

3



1



2









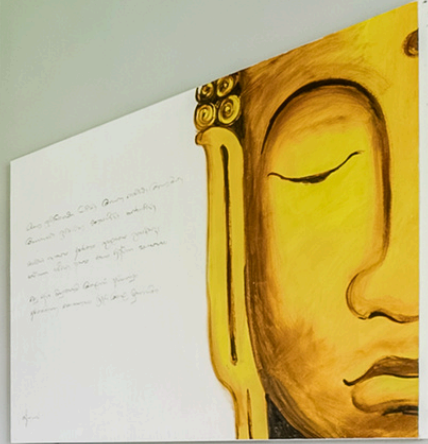



























# The Gables, SG4

Approximate Area = 101.54 sq m / 1093 sq ft

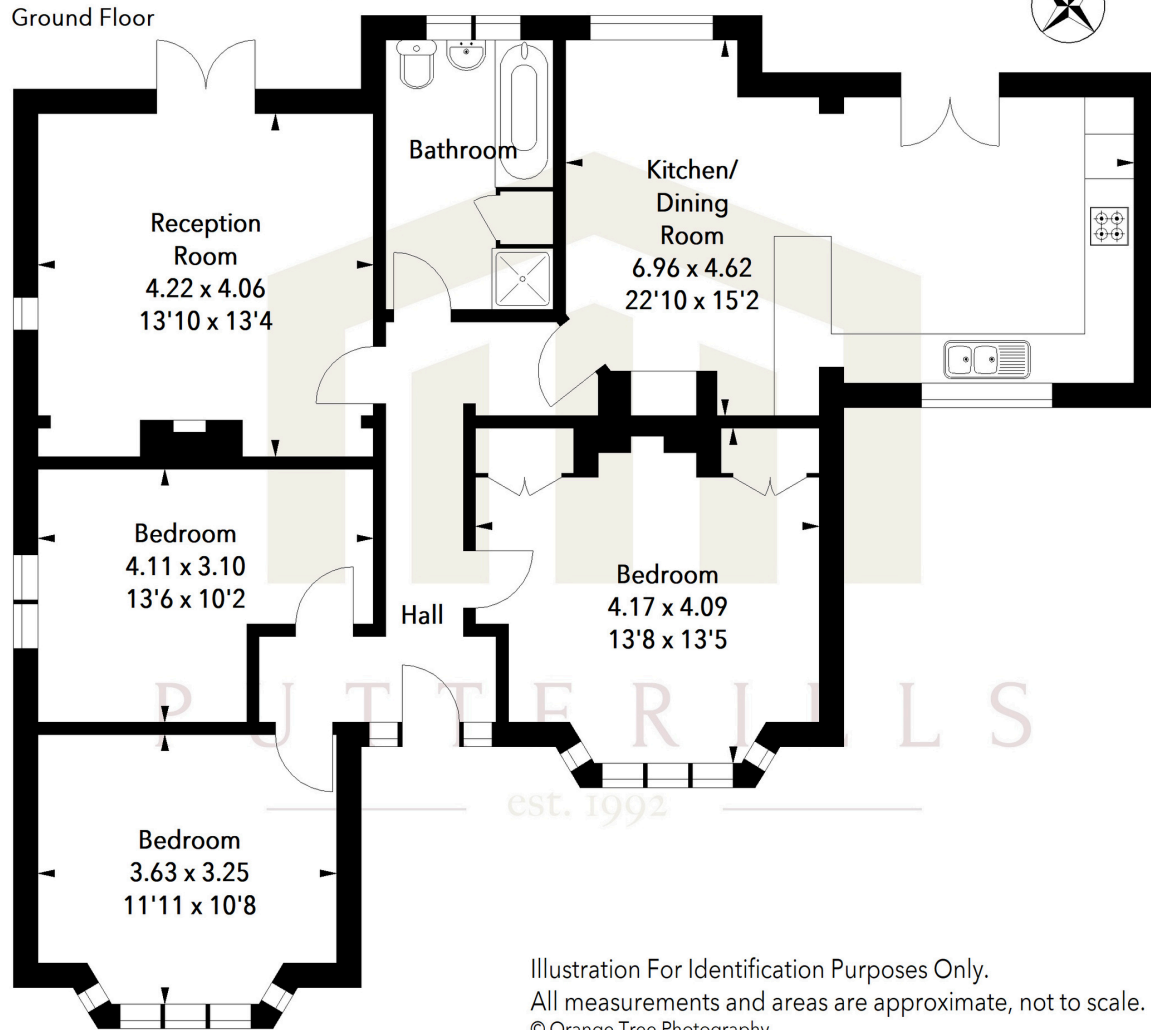

Illustration For Identification Purposes Only.  
All measurements and areas are approximate, not to scale.  
© Orange Tree Photography

LOCAL AUTHORITY  
North Herts

TENURE  
Freehold

COUNCIL TAX BAND: E

VIEWINGS  
By prior appointment only

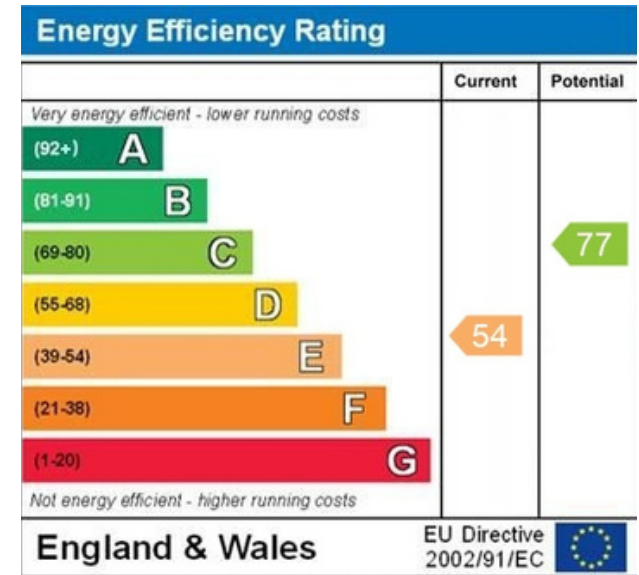

Agents Note: Whilst every care has been taken to prepare these particulars, they are for guidance purposes only. All measurements are approximate and are for general guidance purposes only and whilst every care has been taken to ensure their accuracy, they should not be relied upon and potential buyers/tenants are advised to recheck the measurements



## OFFICE ADDRESS

Putterills Hitchin  
60 Hermitage Road  
Hitchin  
SG5 1DB

## CONTACT DETAILS

01462 632222  
hitchin@putterills.co.uk  
www.putterills.co.uk