



PUTTERILLS

est. 1992



**Queen Anne's Close , Hitchin, SG5 4LP**  
**O.I.E.O £650,000**



## PROPERTY SUMMARY

Welcome to this spacious and well-maintained family home located in the peaceful Queen Anne's Close, Stotfold. Boasting four double bedrooms, two bathrooms, and two reception rooms, this extended property offers a perfect sanctuary for your family to thrive.

Convenience is key with this home's location. Positioned within easy reach of the A1(M), commuting and traveling to nearby towns and cities is a breeze. Arlesey Train Station is just approximately 3 miles away, making it convenient for those who rely on public transportation. Queen Anne's Close is a sought-after location in Stotfold, known for its tranquillity and closeness to amenities. A range of shops, restaurants, and local businesses can be found within a short distance. Families with children will appreciate the proximity to schools, parks, and playgrounds.

4



2



2





















LOCAL AUTHORITY  
Central Bedfordshire

TENURE Freehold  
COUNCIL TAX BAND: E

VIEWINGS  
By prior appointment only

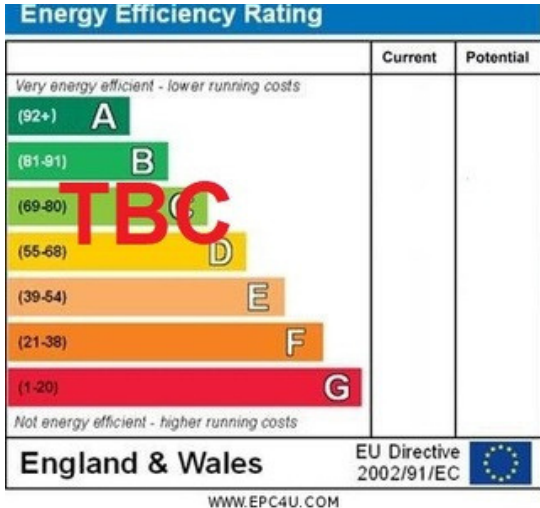
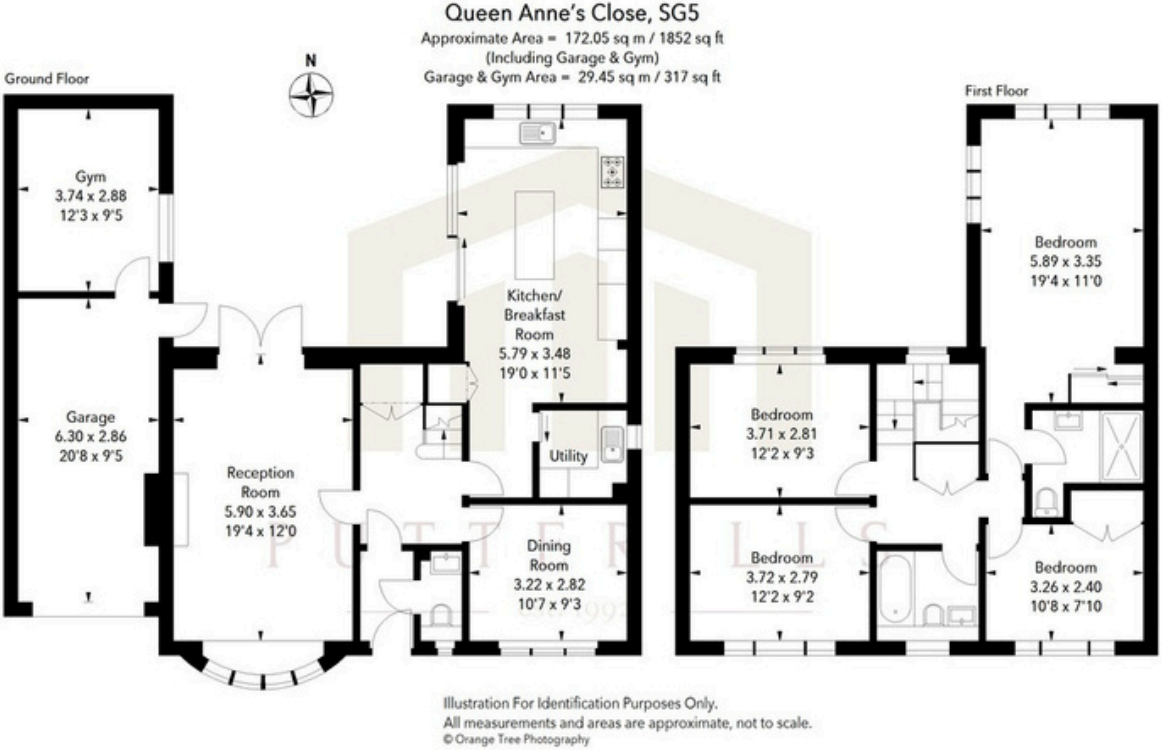

Agents Note: Whilst every care has been taken to prepare these particulars, they are for guidance purposes only. All measurements are approximate and are for general guidance purposes only and whilst every care is taken to ensure their accuracy, they should not be relied upon and potential buyers/tenants are advised to recheck the measurements



OFFICE ADDRESS  
Putterills Hitchin  
60 Hermitage Road  
Hitchin  
SG5 1DB

CONTACT DETAILS  
01462 632222  
hitchin@putterills.co.uk  
www.putterills.co.uk