



PUTTERILLS

est. 1992



Guide Price: £565,000

Silver Lion Gardens, Lilley, LU2 8LH

PROPERTY SUMMARY

This stunning four bedroom house with two bathrooms and two reception rooms offers the perfect blend of style, comfort, and convenience. Don't miss out on this amazing opportunity!

- 4 
- 2 
- 2 









LOCAL AUTHORITY
North Hertfordshire

TENURE
Freehold

COUNCIL TAX BAND
E

VIEWINGS
By prior appointment only

Silver Lion Gardens, LU2

Approximate Area = 128.02 sq m / 1378 sq ft

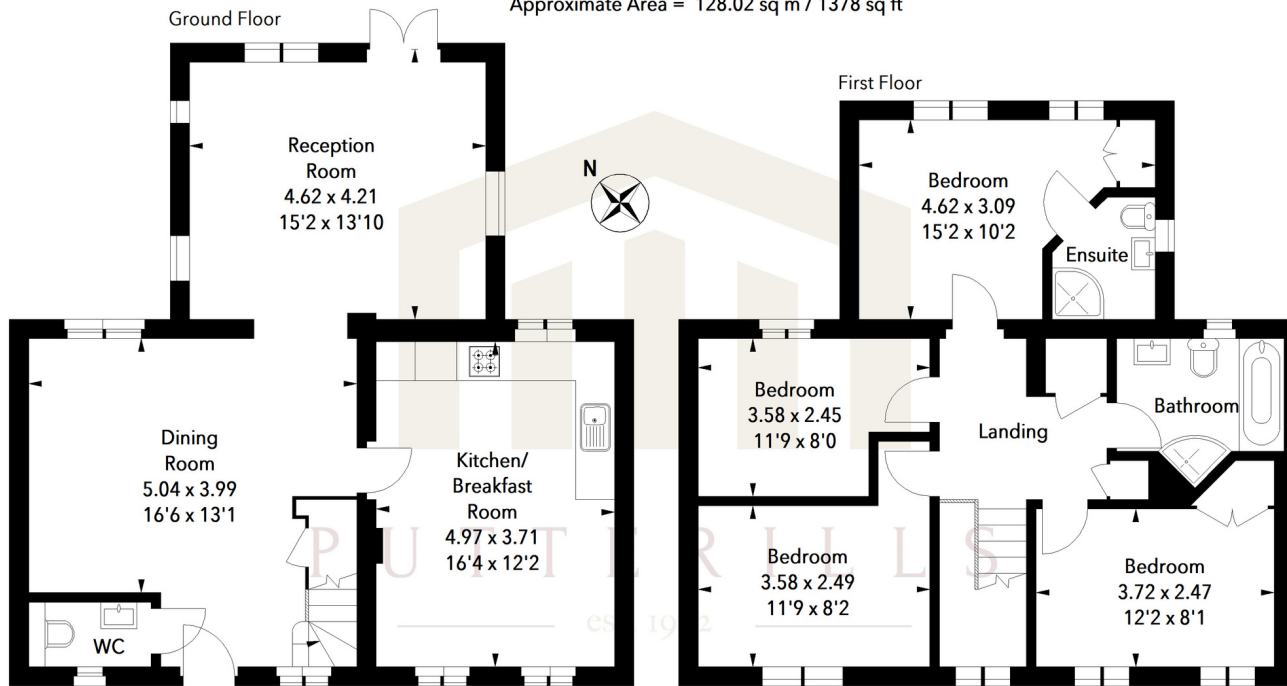
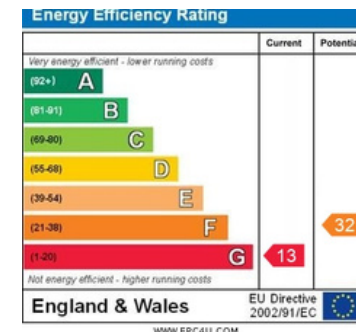

Illustration For Identification Purposes Only.
All measurements and areas are approximate, not to scale.
© Orange Tree Photography



Agents Note: Whilst every care has been taken to prepare these particulars, they are for guidance purposes only. All measurements are approximate and are for general guidance purposes only and whilst every care has been taken to ensure their accuracy, they should not be relied upon and potential buyers/tenants are advised to recheck the measurements



OFFICE ADDRESS

Putterills Hitchin
60 Hermitage Road
Hitchin
SG5 1DB

CONTACT DETAILS

01462 632222
hitchin@putterills.co.uk
www.putterills.co.uk