



Woolgrove Road, Hitchin, SG4 0AU
Guide Price: £875,000
Freehold

PROPERTY SUMMARY

An opportunity to own a beautiful Grade II listed home with 3 Bedrooms, 3 Bathrooms and 3 Reception rooms , Generous Enclosed Garden and Barn-style Double Detached Garage

3



3



3









LOCAL AUTHORITY
North Hertfordshire
TENURE Freehold

COUNCIL TAX BAND
E

VIEWINGS
By prior appointment only

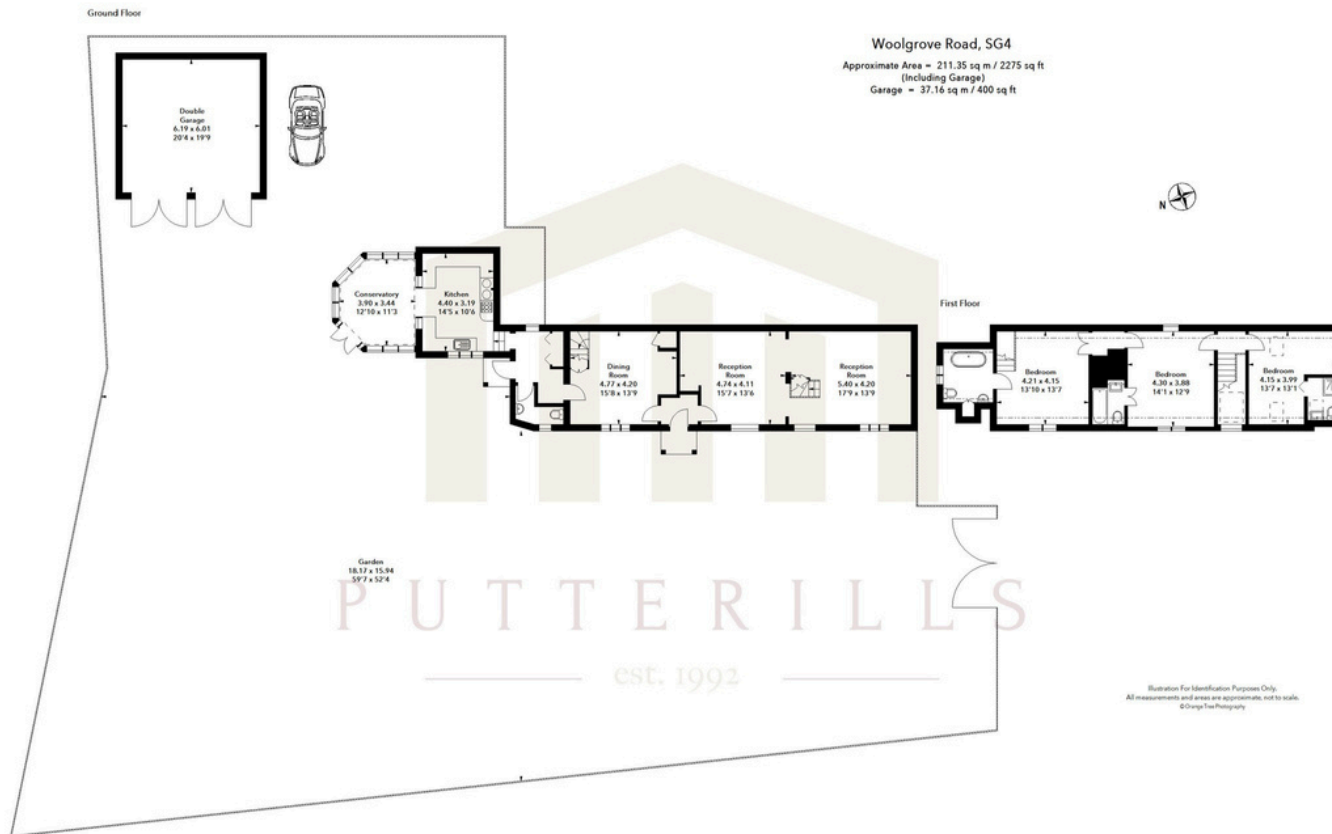

Energy Efficiency Rating		
	Current	Potential
Very energy efficient - lower running costs		
(92+)	A	
(81-91)	B	
(69-80)	C	
(55-68)	D	
(39-54)	E	
(21-38)	F	
(1-20)	G	
Not energy efficient - higher running costs		
England & Wales		EU Directive 2002/91/EC

Agents Note: Whilst every care has been taken to prepare these particulars, they are for guidance purposes only. All measurements are approximate and are for general guidance purposes only and whilst every care has been taken to ensure their accuracy, they should not be relied upon and potential buyers/tenants are advised to recheck the measurements



OFFICE ADDRESS
Putterills Hitchin
60 Hermitage Road
Hitchin
SG5 1DB

CONTACT DETAILS

01462 632222
hitchin@putterills.co.uk
www.putterills.co.uk