

Love Homes



Victoria Grove, Flitwick, Bedfordshire, MK45 1GD

You're welcomed by a bright hallway with a cloakroom. The modern kitchen boasts integrated appliances, ample storage, and worktops, perfect for cooking. The adjacent living room, filled with natural light, opens to a south-east facing garden via French doors. Upstairs are two spacious double bedrooms and a stylish bathroom. Double glazing and gas central heating ensure year-round comfort.

The larger-than-average garden features a lawn, patio, decking, and a timber shed, with fenced boundaries for privacy. A rear gate leads to a driveway offering off-road parking for two cars.

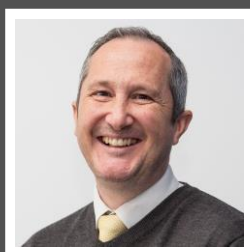

This property is presented by Duncan Stead - a Love Homes property expert with over 25 years' experience.

Find out more about this property by scanning the QR code.



1.0m

Tenure: Freehold



2



1

Council Tax: C



1



"Living on Victoria Grove has been a truly great experience for us. We've loved the warm, friendly community and how welcoming the neighbourhood is - it has been a great place to start our family. The convenient connections to London have been a huge bonus for us when visiting friends and family, while nearby places in Flitwick and Ampthill have provided fantastic options for outings and activities, including lots of great walks and restaurants. We're confident that whoever moves in will enjoy the same sense of community that we've cherished here."



GROUND FLOOR
376 sq.ft. (34.9 sq.m.) approx.

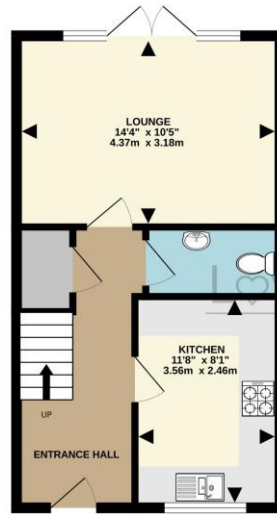

1ST FLOOR
374 sq.ft. (34.7 sq.m.) approx.

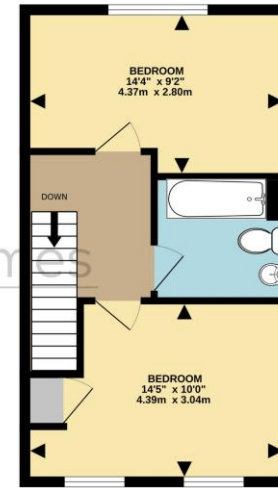

TOTAL FLOOR AREA: 750 sq.ft. (69.7 sq.m.) approx.
Drawn by Love Homes for illustrative purposes only. Measurements and areas shown are approximate.
Made with Metropix ©2025

Score	Energy rating	Current	Potential
92+	A		96 A
81-91	B	83 B	
69-80	C		
55-68	D		
39-54	E		
21-38	F		
1-20	G		

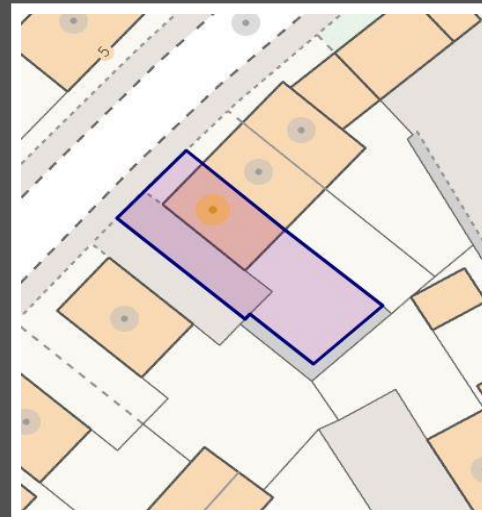

These particulars are set out as a general outline in accordance with the Property Misdescriptions Act (1991) only for the guidance of intending purchasers or lessees, and do not constitute any part of an offer or contract. Details are given without any responsibility, and any intending purchasers, lessees or third parties should not rely on them as statements or representations of fact but must satisfy themselves by inspection or otherwise as to the correctness of each of them. We have not carried out a structural survey and the services, appliances and specific fittings have not been tested. All photographs, measurements, floor plans and distances referred to are given as a guide only and should not be relied upon for the purchase of carpets or any other fixtures or fittings. Gardens, roof terraces, balconies and communal gardens as well as tenure and lease details cannot have their accuracy guaranteed for intending purchasers. Lease details, service ground rent (where applicable) are given as a guide only and should be checked and confirmed by your solicitor prior to exchange of contracts. No person in the employment of Love Homes has any authority to make any representation or warranty whatever in relation to this property. Purchase prices, rents or other prices quoted are correct at the date of publication and, unless otherwise stated, are exclusive of VAT. We retain the copyright in all advertising material used to market this Property. All information is as advised by the seller and subject to change. Council tax bands can be subject to change by the local council.

5 The Russell Centre, Coniston Road, Flitwick, MK45 1QY
Tel: 01525 713111

Email: flitwick@lovehomes.uk

www.lovehomes.uk



Love Homes