

Love Homes



Water Lane, Flitwick, Bedfordshire, MK45 1LD

This home features a spacious 26'2" x 14'6" reception room with garden views and a log burner fireplace, plus a 12'3" study/occasional bedroom. The modern dual-aspect kitchen/breakfast room includes granite worktops and a Rangemaster oven. The ground floor also offers a re-fitted bathroom, while upstairs has three double bedrooms and a shower room. Additional highlights include an integral garage with electric door and internal access, a 75ft rear garden backing onto a River Flit tributary, and stunning countryside views over Flitwick Moor. Perfect for relaxing or entertaining in style.



This property is presented by Duncan Stead - a Love Homes property expert with over 25 years' experience.

Find out more about this property by scanning the QR code.



0.5m



3



2



2

Tenure: Freehold

Council Tax: D



"We were drawn to this house for its perfect mix of convenience and tranquility. The train station is just a short walk away, yet the countryside views make it feel like a peaceful retreat. We've also done a lot to modernise the house, making it stylish and practical for everyday living. The office off the living room has been a great workspace but could easily work as a playroom or a fourth bedroom. It's a versatile home that's been a joy to live in."



GROUND FLOOR
843 sq ft. (78.3 sq.m.) approx.



1ST FLOOR
488 sq ft. (45.4 sq.m.) approx.

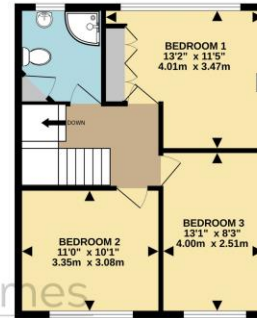

Love Homes

TOTAL FLOOR AREA: 1331 sq ft. (123.7 sq.m.) approx.
Drawn by Love Homes for illustrative purposes only. Measurements and areas shown are approximate.
Made with MyHomeplan 0324

Score	Energy rating	Current	Potential
92+	A		
81-91	B		81 B
69-80	C		
55-68	D	59 D	
39-54	E		
21-38	F		
1-20	G		



These particulars are set out as a general outline in accordance with the Property Misdescriptions Act (1991) only for the guidance of intending purchasers or lessees, and do not constitute any part of an offer or contract. Details are given without any responsibility, and any intending purchasers, lessees or third parties should not rely on them as statements or representations of fact but must satisfy themselves by inspection or otherwise as to the correctness of each of them. We have not carried out a structural survey and the services, appliances and specific fittings have not been tested. All photographs, measurements, floor plans and distances referred to are given as a guide only and should not be relied upon for the purchase of carpets or any other fixtures or fittings. Gardens, roof terraces, balconies and communal gardens as well as tenure and lease details cannot have their accuracy guaranteed for intending purchasers. Lease details, service ground rent (where applicable) are given as a guide only and should be checked and confirmed by your solicitor prior to exchange of contracts. No person in the employment of Love Homes has any authority to make any representation or warranty whatever in relation to this property. Purchase prices, rents or other prices quoted are correct at the date of publication and, unless otherwise stated, are exclusive of VAT. We retain the copyright in all advertising material used to market this Property. All information is as advised by the seller and subject to change. Council tax bands can be subject to change by the local council.

5 The Russell Centre, Coniston Road, Flitwick, MK45 1QY
Tel: 01525 713111

Email: flitwick@lovehomes.uk

www.lovehomes.uk



Love Homes