

Love Homes



The Hawthorns, Flitwick, Bedfordshire MK45 1FL

Chain-free two-bedroom top-floor flat with a balcony, near Flitwick town center and train station. Ideal for first-time buyers, investors, or downsizers, this well-presented property features a living room with a wall-mounted flame effect fire, double doors to a balcony overlooking communal gardens, a modern kitchen with integrated appliances, two double bedrooms, and a contemporary bathroom with an overhead shower. Additional benefits include a telephone security entrance, double glazing, and allocated parking within an exclusive gated development.



This property is presented by Duncan Stead - a Love Homes property expert with over 25 years' experience.

Find out more about this property by scanning the QR code.



0.3m



2



1



1

Tenure: Leasehold

Council Tax: C



♥

"When I first saw this flat with its private outdoor space, I knew I had to make it mine. That was six years ago, and I've loved every minute here. The living room with its French doors that open right onto the balcony has been an absolute joy - especially during the lockdowns. It's a great spot to relax and get some fresh air without leaving home. Being on the top floor adds that extra layer of security which is a big comfort when I'm away. The two spacious double bedrooms have been perfect for hosting family and friends; it's nice to have that extra room when loved ones visit. And if you commute, the location couldn't be more convenient. The train station is just a short walk away close enough that even a rainy day won't be a hassle. If it weren't for work commitments taking me elsewhere, I'd stay here much longer."



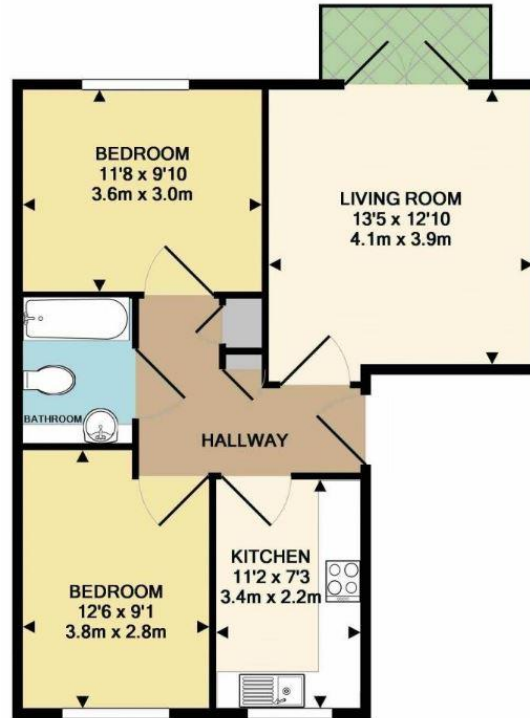

TOTAL APPROX. FLOOR AREA 586 SQ.FT. (54.4 SQ.M.)

Score	Energy rating	Current	Potential
92+	A		
81-91	B		
69-80	C		
55-68	D		
39-54	E		
21-38	F		
1-20	G		

EPC RATING TO FOLLOW



These particulars are set out as a general outline in accordance with the Property Misdescriptions Act (1991) only for the guidance of intending purchasers or lessees, and do not constitute any part of an offer or contract. Details are given without any responsibility, and any intending purchasers, lessees or third parties should not rely on them as statements or representations of fact but must satisfy themselves by inspection or otherwise as to the correctness of each of them. We have not carried out a structural survey and the services, appliances and specific fittings have not been tested. All photographs, measurements, floor plans and distances referred to are given as a guide only and should not be relied upon for the purchase of carpets or any other fixtures or fittings. Gardens, roof terraces, balconies and communal gardens as well as tenure and lease details cannot have their accuracy guaranteed for intending purchasers. Lease details, service ground rent (where applicable) are given as a guide only and should be checked and confirmed by your solicitor prior to exchange of contracts. No person in the employment of Love Homes has any authority to make any representation or warranty whatever in relation to this property. Purchase prices, rents or other prices quoted are correct at the date of publication and, unless otherwise stated, are exclusive of VAT. We retain the copyright in all advertising material used to market this Property. All information is as advised by the seller and subject to change. Council tax bands can be subject to change by the local council.

5 The Russell Centre, Coniston Road, Flitwick, MK45 1QY
Tel: 01525 713111

Email: flitwick@lovehomes.uk

www.lovehomes.uk



Love Homes